

**NOTICE!!**

**These documents have been scanned!**

**Do not place un-scanned documents beneath this notice!**

**Do not remove this notice from this file!**

GPO Jacket No. 560-102  
Print Order 61540  
Rise Business Services, LLC  
Job=AZ15 6/5/2019



Box Number= AZ15118



Claim Begin-End: AMC361755-AMC361756

**1 Initial Receipt**



AZ15118-4 AMC361381-AMC361966

**United States Department of the Interior  
Bureau of Land Management**

BUSINESS & SUPPORT SVCS DIV  
222 N CENTRAL AVE  
PHOENIX, AZ 85004 -2203  
Phone: (602) 417-9200

<b>Receipt</b>	
<b>No:</b>	<b>1110433</b>

**Transaction #:** 1149143  
**Date of Transaction:** 07/15/2005

<b>CUSTOMER:</b>	D.D.EXPLORATION 2207 CRESCENT DR DODGE CITY,KS 67801
------------------	------------------------------------------------------------

LINE #	QTY	DESCRIPTION	REMARKS	UNIT PRICE	TOTAL
1	1.00	LOCATABLE MINERALS / MINING CLAIMS-NOT NEW-UNADJUD,ONE AUTH NO. ONLY / MINING CLAIM MONEY RECEIVED (455) <b>CASES: AMC361755/\$20.00</b>	AMEND (4)	- n/a -	<b>20.00</b>
<b>TOTAL:</b>					<b>\$20.00</b>

PAYMENT INFORMATION					
1	<b>AMOUNT:</b>	\$20.00	<b>POSTMARKED:</b>	07/08/2005	
	<b>TYPE:</b>	CHECK	<b>RECEIVED:</b>	07/12/2005	
	<b>CHECK NO:</b>	8614			
	<b>NAME:</b>	MYERS, PETER D 2207 CRESCENT DR DODGE CITY KS 67801			

REMARKS

This receipt was generated by the automated BLM Collections and Billing System and is a paper representation of a portion of the official electronic record contained therein.

**United States Department of the Interior**  
**Bureau of Land Management**  
 BUSINESS & SUPPORT SVCS DIV  
 222 N CENTRAL AVE  
 PHOENIX, AZ 85004 -2203  
 Phone: (602) 417-9200

Receipt

No: 884119

**ENTERED INTO COMPUTER**  
 JUN 09 2004 

Transaction #: 917371  
 Date of Transaction: 06/01/2004

CUSTOMER: D D EXPLORATION  
 2207 CRESCENT DR  
 DODGE CITY,KS 67801

LINE #	QTY	DESCRIPTION	REMARKS	UNIT PRICE	TOTAL
1	2.00	LOCATABLE MINERALS / MINING CLAIMS-NEW, UNADJUDI, ONE OR MORE AUTH NO'S / NEW MINING CLAIM LOCATION FEE \$25(1993) <b>CASES:</b> AMC361755/\$25.00, AMC361756/\$25.00		- n/a -	50.00
2	2.00	LOCATABLE MINERALS / MINING CLAIMS-NEW, UNADJUDI, ONE OR MORE AUTH NO'S / NEW MINING CLAIM SVC CHG \$10 (1930) <b>CASES:</b> AMC361755/\$10.00, AMC361756/\$10.00		- n/a -	20.00
3	2.00	LOCATABLE MINERALS / MINING CLAIMS-NEW, UNADJUDI, ONE OR MORE AUTH NO'S / NEW MINING CLM MAINT FEE \$100(1993) <b>CASES:</b> AMC361755/\$100.00, AMC361756/\$100.00		- n/a -	200.00
<b>TOTAL:</b>					<b>\$270.00</b>

PAYMENT INFORMATION			
1	AMOUNT:	\$270.00	POSTMARKED: N/A
	TYPE:	CHECK	RECEIVED: 06/01/2004
	CHECK NO:	7953	
	NAME:	MYERS, PETER D 2207 CRESCENT DR DODGE CITY KS 67801	

REMARKS

This receipt was generated by the automated BLM Collections and Billing System and is a paper representation of a portion of the official electronic record contained therein.

**NOTICE!!**

**These documents have been scanned!**

**Do not place un-scanned documents beneath this notice!**

**Do not remove this notice from this file!**

GPO Jacket No. 560-102  
Print Order 61540  
Rise Business Services, LLC  
Job=AZ15 6/5/2019



Box Number= AZ15118



Claim Begin-End: AMC361755-AMC361756

**2 Correspondence**



AZ15118-4 AMC361381-AMC361966



# United States Department of the Interior



BUREAU OF LAND MANAGEMENT

Arizona State Office

One North Central Avenue, Suite 800

Phoenix, Arizona 85004-4427

[www.blm.gov/az/](http://www.blm.gov/az/)

OCT 07 2016

In Reply Refer To:

3800 (9200) RM

AMC361755, AMC366532, AMC383267, *AMC361955*

CERTIFIED MAIL - RETURN RECEIPT REQUESTED No. 7016 1370 0001 2495 2882

## DECISION

P M EXPL LLC; MYERS PETE : This decision affects those claims shown  
2207 CRESCENT DR : on the attached list(s).  
DODGE CITY, KS 67801-2827 :

---

SEE ENCLOSURE FOR LIST OF CLAIMS

---

### MINING CLAIMS DECLARED FORFEIT

The mining claims listed above have been declared forfeit as of September 1, 2016, for failure to timely file the required maintenance fee payment or small miner's maintenance fee waiver (waiver).

Claimants are required to pay an annual non-refundable maintenance fee of \$155 per 20 acres or portion thereof, or submit a waiver, on or before September 1 of each year. These requirements were established by 30 U.S.C. 28f-1, as amended, and 43 CFR 3834 and 3835.

Our records do not show receipt of a maintenance fee payment or small miner waiver filed on or before the due date. Therefore, the claims listed above are forfeit.

### Reclamation Requirements

This decision does not relieve you of the liability for reclamation of all areas disturbed by your activities on lands covered by the subject mining claim(s) and/or site(s). After you complete the reclamation, you must notify the authorized officer of the appropriate surface managing agency so that the authorized officer may conduct a final site inspection and determine whether you may be released from liability. If you fail to reclaim the land to the satisfaction of the authorized officer, the surface management agency may cite you for noncompliance under its surface management regulations. For land administered by the Bureau of Land Management (BLM), if you fail to

reclaim the land to the satisfaction of the authorized officer as required in 43 CFR Subpart 3809, BLM will issue an order of noncompliance under 43 CFR 3809.601(a). If you fail to comply with the non-compliance order, BLM may take further action under 43 CFR 3809.604. Failure to conduct reclamation is a prohibited act that may subject you to criminal penalties. See 43 CFR 3809.605(h) and 43 CFR 3809.700.

### Appeal Procedures

This decision may be appealed to the Interior Board of Land Appeals, Office of the Secretary, in accordance with the regulations contained in 43 CFR, Part 4, and the enclosed Form 1842-1. If an appeal is taken, your notice of appeal must be filed in this office (at the above address) within 30 days from receipt of this decision. The appellant has the burden of showing that the decision appealed from is in error.

If you wish to file a petition pursuant to regulation 43 CFR 4.21 (58 FR 4939, January 19, 1993) for a stay of the effectiveness of this decision during the time that your appeal is being reviewed by the Board, the petition for a stay must accompany your notice of appeal. A petition for a stay is required to show sufficient justification based on the standards listed below. Copies of the notice of appeal and petition for a stay **must** also be submitted to each party named in this decision and to the Interior Board of Land Appeals and to the appropriate Office of the Solicitor (see 43 CFR 4.413) at the same time the original documents are filed with this office. If you request a stay, you have the burden of proof to demonstrate that a stay should be granted.

### Standards for Obtaining a Stay

Except as otherwise provided by law or other pertinent regulation, a petition for a stay of a decision pending appeal shall show sufficient justification based on the following standards:

- (1) The relative harm to the parties if the stay is granted or denied,
- (2) The likelihood of the appellant's success on the merits,
- (3) The likelihood of immediate and irreparable harm if the stay is not granted, and
- (4) Whether the public interest favors granting the stay.

Please include your AMC serial number(s) on all correspondence. If additional information is required, please call RéAnn Myers at 602-417-9413.



Rebecca Heick  
Deputy State Director  
Lands, Minerals, and Energy Division

Enclosure

**SENDER: COMPLETE THIS SECTION**

- Complete items 1, 2, and 3.
- Print your name and address on the reverse so that we can return the card to you.
- Attach this card to the back of the mailpiece, or on the front if space permits.

## 1. Article Addressed to:

P M EXPL LLC; MYERS PETE  
 2207 CRESCENT DR  
 DODGE CITY KS 67801-2827  
 920/RM/AMC361755, AMC366532,  
 AMC383267



9590 9402 1825 6104 0397 51

## 2. Article Number (Transfer from service label)

7016 1370 0001 2495 2882

**COMPLETE THIS SECTION ON DELIVERY**

## A. Signature

X

## B. Received by (Printed Name)

Pete Myers

 Agent Addressee

## C. Date of Delivery

OCT 17 2016

- D. Is delivery address different from item 1?  Yes  
 If YES, enter delivery address below:  No

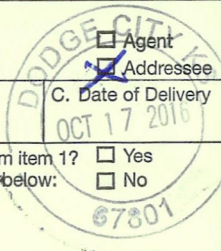

## 3. Service Type

- |                                                                  |                                                                     |
|------------------------------------------------------------------|---------------------------------------------------------------------|
| <input type="checkbox"/> Adult Signature                         | <input type="checkbox"/> Priority Mail Express®                     |
| <input type="checkbox"/> Adult Signature Restricted Delivery     | <input type="checkbox"/> Registered Mail™                           |
| <input checked="" type="checkbox"/> Certified Mail®              | <input type="checkbox"/> Registered Mail Restricted Delivery        |
| <input type="checkbox"/> Certified Mail Restricted Delivery      | <input type="checkbox"/> Return Receipt for Merchandise             |
| <input type="checkbox"/> Collect on Delivery                     | <input checked="" type="checkbox"/> Signature Confirmation™         |
| <input type="checkbox"/> Collect on Delivery Restricted Delivery | <input type="checkbox"/> Signature Confirmation Restricted Delivery |

USPS TRACKING #

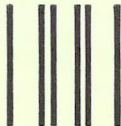
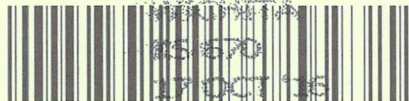

First-Class Mail  
Postage & Fees Paid  
USPS  
Permit No. G-10

9590 9402 1825 6104 0397 51

United States  
Postal Service

RECEIVED  
BLM AZ STATE OFFICE

2016 OCT 24 PM 2:14

PHOENIX, ARIZONA

• Sender: Please print your name, address, and ZIP+4® in this box•

UNITED STATES  
DEPARTMENT OF THE INTERIOR  
Bureau of Land Management  
Arizona State Office  
One N. Central Avenue, Suite 800  
Phoenix, AZ 85004-4427

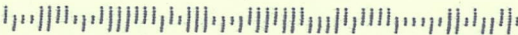



P M EXPL LLC; MYERS PETE  
2207 CRESCENT DR  
DODGE CITY KS 67801-2827

<u>LEAD FILE NUMBER</u>	<u>CLAIM NUMBER</u>	<u>CLAIM NAME</u>
AMC361755	AMC361756	N.D. #11
AMC361955	AMC361956	N.D.#13
AMC366532	AMC366532	KPD#001
AMC366532	AMC366533	KPD#004
AMC366532	AMC366534	KPD#005
AMC366532	AMC366535	KPD#006
AMC366532	AMC366537	KPD#009
AMC366532	AMC366539	KPD#015
AMC366532	AMC366542	KPD#018
AMC366532	AMC366543	KPD#019
AMC366532	AMC366545	KPD#021
AMC366532	AMC366546	KPD#022
AMC366532	AMC366547	KPD#023
AMC366532	AMC366548	KPD#024
AMC366532	AMC366549	KPD#025
AMC366532	AMC366550	KPD#026
AMC366532	AMC366551	KPD#027
AMC366532	AMC366552	KPD#034
AMC366532	AMC366554	KPD#043
AMC366532	AMC366555	KPD#048
AMC366532	AMC366556	KPD#057
AMC366532	AMC366557	KPD#060
AMC383267	AMC383267	KPD 010
AMC383267	AMC383268	KPD 011
AMC383267	AMC383270	KPD 030

**NOTICE!!**

**These documents have been scanned!**

**Do not place un-scanned documents beneath this notice!**

**Do not remove this notice from this file!**

GPO Jacket No. 560-102  
Print Order 61540  
Rise Business Services, LLC  
Job=AZ15 6/5/2019



Box Number= AZ15118



Claim Begin-End: AMC361755-AMC361756

**3 Transfers**



AZ15118-4 AMC361381-AMC361966

**QUIT CLAIM DEED**  
**(Following Kansas Statutory Form)**

AMC 361755  
AMC 361955

**D.D. EXPLORATION LLC**

QUIT CLAIMS TO

**P.M. EXPLORATION LLC**

all the following described REAL ESTATE in the County of COCHISE,  
and the State of ARIZONA, to-wit:

<u>CLAIM NAME</u>	<u>BLM AMC #</u>	<u>COCHISE COUNTY RECORDING #</u>
N.D.#10	AMC361755	040617412
N.D.#11	AMC361756	040617413
N.D.#12	AMC361955	040620541
N.D.#13	AMC361956	040620540

Located within Section 30, Township 23 South, Range 20 East, G&SRM, Arizona, and this claim encompasses portions of the Southwest Quarter (SW/4) Section 30, Township 23 South, Range 20 East, G&SRM, Arizona, in Cochise County.

for the sum of: Ten Dollars and other good and valuable consideration.

DATED: May 2, 2007

*Pete Myers*  
D.D. EXPLORATION LLC  
BY PETE MYERS,  
GENERAL PARTNER

BLM RECEIVED  
2007 OCT 26 A 7:45  
PHOENIX, ARIZONA  
STATE OFFICE

STATE OF KANSAS, FORD COUNTY, SS

BE IT REMEMBERED, That on this 2<sup>nd</sup> day of May, 2007, before me the undersigned, a Notary Public in and for the County and State aforesaid, **D.D. EXPLORATION LLC By PETE MYERS, GENERAL PARTNER**, who is personally known to me to be the same person who executed the within instrument of writing and such persons duly acknowledged the execution of the same.

WITNESS WHEREOF, I have hereunto set my hand and affixed my seal, the day and year last above written.

Term expires: 

*Joyce M. Lies*  
JOYCE M LIES, Notary Public

**ENTERED INTO COMPUTER**  
12/19/07 AB

**United States Department of the Interior**  
**Bureau of Land Management**  
 BUSINESS & SUPPORT SVCS DIV  
 ONE N CENTRAL AVE SUITE 800  
 PHOENIX, AZ 85004 -4427  
 Phone: (602) 417-9200

Receipt

No: 1593289

<b>Transaction #:</b> 1645628	
<b>Date of Transaction:</b> 10/29/2007	
<b>CUSTOMER:</b>	PETE MYERS 2207 CRESCENT DR DODGE CITY,KS 67801

LINE #	QTY	DESCRIPTION	REMARKS	UNIT PRICE	TOTAL
1	1.00	LOCATABLE MINERALS / MINING CLAIMS-NOT NEW-UNADJUD,ONE AUTH NO. ONLY / MINING CLAIM MONEY RECEIVED (455) CASES: AMC361755/\$40.00	TRF (4)	- n/a -	40.00
<b>TOTAL:</b>					<b>\$40.00</b>

PAYMENT INFORMATION				
NOTE: Items will appear on credit card statement as "Bureau of Land Management".				
1	AMOUNT:	\$40.00	POSTMARKED:	N/A
	TYPE:	CREDIT CARD	RECEIVED:	10/29/2007
	NAME:	MYERS, PETE 2207 CRESCENT DR DODGE CITY KS 67801		
	CARD NO:	XXXXXXXXXXXX9231	AUTH CODE:	01542B
	NAME ON CARD:	PETE MYERS		
	EXPIRES:	06/30/2009		
	SIGNATURE:			

REMARKS

This receipt was generated by the automated BLM Collections and Billing System and is a paper representation of a portion of the official electronic record contained therein.

**NOTICE!!**

**These documents have been scanned!**

**Do not place un-scanned documents beneath this notice!**

**Do not remove this notice from this file!**

GPO Jacket No. 560-102  
Print Order 61540  
Rise Business Services, LLC  
Job=AZ15 6/5/2019



Box Number= AZ15118



Claim Begin-End: AMC361755-AMC361756

**4 Annual Filings**



AZ15118-4

AMC361381-AMC361966

361755  
361955  
366532  
383267

Notice Of Intention To Hold Mining Claim(s)

This Notice of Intention to Hold Mining Claim(s) is made pursuant to 43 C.F.R., subpart 3833.2.3, by:

Name (owner or agent) P.M. EXPLORATION LLC

Address 2207 CRESCENT DRIVE

City, State, Zip DODGE CITY, KS. 67801

Claim Name	BLM AMC#	Cochise County Recording #
<u>N.D.#10</u>	<u>AMC361755</u>	<u>040617412</u>
<u>N.D.#12</u>	<u>AMC361955</u>	<u>040620541</u>
<u>KPD#008</u>	<u>AMC366536</u>	<u>050725419</u>
<u>KPD#012</u>	<u>AMC366538</u>	<u>050725420</u>
<u>KPD#016</u>	<u>AMC366540</u>	<u>050725422</u>
<u>KPD#017</u>	<u>AMC366541</u>	<u>050725423</u>
<u>KPD#020</u>	<u>AMC366544</u>	<u>050725426</u>
<u>KPD#029</u>	<u>AMC383269</u>	<u>070517896</u>
<u>KPD#035</u>	<u>AMC366553</u>	<u>050725435</u>

RECEIVED  
BLM AZ STATE OFFICE  
2018 AUG 29 P 2:32  
PHOENIX, ARIZONA

The above named claim(s) is (are) held claimed by the owner(s) for the valuable mineral contained therein. I (we) intend to continue development of the claim(s).

Annual assessment work or report of geological, geochemical or geophysical survey is not required because the owner has paid a rental fee of \$155.00 per claim for the assessment year ending August 31, 2018 and is paying \$155.00 per claim for an advanced rental fee for the assessment work for the year beginning on September 1, 2018.

Signed [Signature]

Date 8-28-18

ENTERED  
SEP 05 2018  
BY: RAM

# 4251546

PRESS FIRMLY TO SEAL

PRESS FIRMLY TO SEAL



1007

85004

U.S. POSTAGE PAID  
PME 1-DAY  
DODGE CITY, KS  
67801  
AUG 28 18  
AMOUNT

**\$24.70**  
R2304M114140-04

# PRIORITY ★ MAIL ★ EXPRESS™

OUR FASTEST SERVICE IN THE U.S.

RECEIVED  
M AZ STATE OFFICE  
AUG 29 P 2:32  
PHOENIX, ARIZONA

WHEN USED INTERNATIONALLY,  
A CUSTOMS DECLARATION  
LABEL MAY BE REQUIRED.



EP13F July 2013 OD: 12.5 x 9.5



PS1000100006

VISIT US AT **USPS.COM**®  
ORDER FREE SUPPLIES ONLINE



WRITE FIRMLY WITH BALL POINT PEN ON HARD SURFACE TO MAKE ALL COPIES LEGIBLE.

**CUSTOMER USE ONLY**

FROM: (PLEASE PRINT) PHONE ( )

*PLM  
207  
Dodge City KS*

PAYMENT BY ACCOUNT (if applicable)

**DELIVERY OPTIONS (Customer Use Only)**

SIGNATURE REQUIRED Note: The mailer must check the "Signature Required" box if the mailer: 1) Requires the addressee's signature; OR 2) Purchases additional insurance; OR 3) Purchases COD service; OR 4) Purchases Return Receipt service. If the box is not checked, the Postal Service will leave the item in the addressee's mail receptacle or other secure location without attempting to obtain the addressee's signature on delivery.

**Delivery Options**

No Saturday Delivery (delivered next business day)

Sunday/Holiday Delivery Required (additional fee, where available\*)

10:30 AM Delivery Required (additional fee, where available\*)

\*Refer to USPS.com® or local Post Office™ for availability.

TO: (PLEASE PRINT) PHONE ( )

*PLM  
207  
Dodge City KS*

ZIP + 4® (U.S. ADDRESSES ONLY)

*65004*

**ORIGIN (POSTAL SERVICE USE ONLY)**

1-Day  2-Day  Military  DPO

PO ZIP Code <i>67801</i>	Scheduled Delivery Date (MM/DD/YY) <i>9-11-18</i>	Postage \$ <i>24.70</i>	
Date Accepted (MM/DD/YY) <i>8/28/18</i>	Scheduled Delivery Time <input type="checkbox"/> 10:30 AM <input type="checkbox"/> 9:00 PM <input type="checkbox"/> 12 NOON	Insurance Fee \$	COD Fee \$
Time Accepted <i>4:12</i>	<input type="checkbox"/> AM <input type="checkbox"/> PM	10:30 AM Delivery Fee \$	Return Receipt Fee \$
Special Handling/Fragile \$	Sunday/Holiday Premium Fee \$	Total Postage & Fees \$ <i>24.70</i>	
Weight lbs. ozs.	Acceptance Employee Initials <i>11</i>		

**DELIVERY (POSTAL SERVICE USE ONLY)**

Delivery Attempt (MM/DD/YY) Time	<input type="checkbox"/> AM <input type="checkbox"/> PM	Employee Signature
Delivery Attempt (MM/DD/YY) Time	<input type="checkbox"/> AM <input type="checkbox"/> PM	Employee Signature

LABEL 11-B, OCTOBER 2016 PSN 7690-02-000-9996 3-ADDRESSEE COPY

This packaging is the property of the U.S. Postal Service® and is provided solely for use in sending Priority Mail Express™ shipments. Misuse may be a violation of federal law. This packaging is not for resale. EP13F © U.S. Postal Service; July 2013; All rights reserved.

**United States Department of the Interior**  
**Bureau of Land Management**  
 DIV OF LANDS, MINRLS & ENERGY  
 ONE N CENTRAL AVE  
 PHOENIX, AZ 85004 -4427  
 Phone: 602-417-9200

Receipt

No: 4251546

<b>Transaction #:</b> 4367058	
<b>Date of Transaction:</b> 08/31/2018	
<b>CUSTOMER:</b>	
PETER D MYERS 2207 CRESCENT DR DODGE CITY,KS 67801-2827 US	

LINE #	QTY	DESCRIPTION	REMARKS	UNIT PRICE	TOTAL
1	1.00	LOCATABLE MINERALS / MINING CLAIMS- NOT NEW-UNADJUD, ONE AUTH NO. ONLY / MINING CLAIM MONEY RECEIVED <b>CASES: AMC361755/\$1395.00</b>	MAINT 2019/1395	- n/a -	1395.00
<b>TOTAL:</b>					<b>\$1,395.00</b>

PAYMENT INFORMATION			
1	AMOUNT:	1395.00	POSTMARKED: N/A
	TYPE:	CHECK	RECEIVED: 08/29/2018
	CHECK NO:	4611	
	NAME:	MYERS, PETER D 2207 CRESCENT DR DODGE CITY KS 67801-2827 US	

REMARKS

This receipt was generated by the automated BLM Collections and Billing System and is a paper representation of a portion of the official electronic record contained therein.



361755  
361955  
366532

Notice Of Intention To Hold Mining Claim(s)

This Notice of Intention to Hold Mining Claim(s) is made pursuant to 43 C.F.R., subpart 3833.2.3, by:

Name (owner or agent) P.M. EXPLORATION LLC

Address 2207 CRESCENT DRIVE

City, State, Zip DODGE CITY, KS. 67801

Claim Name	BLM AMC#	Cochise County Recording #
<u>N.D.#10</u>	<u>AMC361755</u>	<u>040617412</u>
<u>N.D.#12</u>	<u>AMC361955</u>	<u>040620541</u>
<u>KPD#008</u>	<u>AMC366536</u>	<u>050725419</u>
<u>KPD#012</u>	<u>AMC366538</u>	<u>050725420</u>
<u>KPD#016</u>	<u>AMC366540</u>	<u>050725422</u>
<u>KPD#017</u>	<u>AMC366541</u>	<u>050725423</u>
<u>KPD#020</u>	<u>AMC366544</u>	<u>050725426</u>
<u>KPD#029</u>	<u>AMC383269</u>	<u>070517896</u>
<u>KPD#035</u>	<u>AMC366553</u>	<u>050725435</u>

RECEIVED  
BLM AZ STATE OFFICE  
2017 AUG 22 A 7:34  
PHOENIX, ARIZONA

383267

The above named claim(s) is (are) held claimed by the owner(s) for the valuable mineral contained therein. I (we) intend to continue development of the claim(s).

Annual assessment work or report of geological, geochemical or geophysical survey is not required because the owner has paid a rental fee of \$155.00 per claim for the assessment year ending August 31, 2017 and is paying \$155.00 per claim for an advanced rental fee for the assessment work for the year beginning on September 1, 2017.

Signed [Signature]

Date 7-16-17

# 3949897

ENTERED  
AUG 24 2017  
BY: [Signature]

**United States Department of the Interior  
Bureau of Land Management**

Receipt

DIV OF LANDS, MINRLS & ENERGY  
ONE N CENTRAL AVE  
PHOENIX, AZ 85004 -4427  
Phone: 602-417-9200

No: 3949897

<b>Transaction #:</b> 4059625	
<b>Date of Transaction:</b> 08/22/2017	
CUSTOMER:	
PETER D MYERS 2207 CRESCENT DR DODGE CITY,KS 67801-2827 US	

LINE #	QTY	DESCRIPTION	REMARKS	UNIT PRICE	TOTAL
1	1.00	LOCATABLE MINERALS / MINING CLAIMS- NOT NEW-UNADJUD,ONE AUTH NO. ONLY / MINING CLAIM MONEY RECEIVED <b>CASES: AMC361755/\$1485.00</b>	MAINT 2018/9	- n/a -	1485.00
<b>TOTAL:</b>					<b>\$1,485.00</b>

PAYMENT INFORMATION					
1	AMOUNT:	1485.00	POSTMARKED:	08/17/2017	
	TYPE:	CHECK	RECEIVED:	08/22/2017	
	CHECK NO:	4216			
	NAME:	MYERS, PETER D 2207 CRESCENT DR DODGE CITY KS 67801-2827 US			

REMARKS

This receipt was generated by the automated BLM Collections and Billing System and is a paper representation of a portion of the official electronic record contained therein.

**United States Department of the Interior**  
**Bureau of Land Management**  
 DIV OF LANDS, MINRLS & ENERGY  
 ONE N CENTRAL AVE  
 PHOENIX, AZ 85004 -4427  
 Phone: 602-417-9200

Receipt *Find paperwork*

No: 3949897

<b>Transaction #:</b> 4059625	
<b>Date of Transaction:</b> 08/22/2017	
<b>CUSTOMER:</b>	
PETER D MYERS 2207 CRESCENT DR DODGE CITY,KS 67801-2827 US	

LINE #	QTY	DESCRIPTION	REMARKS	UNIT PRICE	TOTAL
1	1.00	LOCATABLE MINERALS / MINING CLAIMS- NOT NEW-UNADJUD, ONE AUTH NO. ONLY / MINING CLAIM MONEY RECEIVED <b>CASES: AMC361755/\$1485.00</b>	MAINT 2018/9	- n/a -	1485.00
<b>TOTAL:</b>					<b>\$1,485.00</b>

*R?  
90  
over?*

PAYMENT INFORMATION			
1	AMOUNT:	1485.00	POSTMARKED: 08/17/2017
	TYPE:	CHECK	RECEIVED: 08/22/2017
	CHECK NO:	4216	
	NAME:	MYERS, PETER D 2207 CRESCENT DR DODGE CITY KS 67801-2827 US	

REMARKS

This receipt was generated by the automated BLM Collections and Billing System and is a paper representation of a portion of the official electronic record contained therein.

*10/10/2017 \$90 REFUND PROCESSED  
FOR OVERPAYMENT.  
379 ENTERED ON  
AMC 361755. PM*

**Authorized Date**10/10/2017

**Instructions to Accounts** AZ BLM REFUND \$90, TO PETER D MYERS, FOR OVERPAYMENT,  
ON AMC361755, RECEIPT #3949897. RM

**Login ID**6222

**Entry Date**10/10/2017

**Total Amount**\$90.00

Notice Of Intention To Hold Mining Claim(s)

361755  
361955  
366532  
383267

This Notice of Intention to Hold Mining Claim(s) is made pursuant to 43 C.F.R., subpart 3833.2.3, by:

RECEIVED  
BLM AZ STATE OFFICE

Name (owner or agent) P.M. EXPLORATION LLC

2016 AUG 30 P 1:59

Address 2207 CRESCENT DRIVE

PHOENIX, ARIZONA

City, State, Zip DODGE CITY, KS. 67801

Claim Name                      BLM AMC#                      Cochise County Recording #

N.D.#10                      AMC361755                      040617412

N.D.#12                      AMC361955                      040620541

KPD#008                      AMC366536                      050725419

KPD#012                      AMC366538                      050725420

KPD#016                      AMC366540                      050725422

KPD#017                      AMC366541                      050725423

KPD#020                      AMC366544                      050725426

KPD#029                      AMC383269                      070517896

KPD#035                      AMC366553                      050725435

The above named claim(s) is (are) held claimed by the owner(s) for the valuable mineral contained therein. I (we) intend to continue development of the claim(s).

Annual assessment work or report of geological, geochemical or geophysical survey is not required because the owner has paid a rental fee of \$155.00 per claim for the assessment year ending August 31, 2016 and is paying \$155.00 per claim for an advanced rental fee for the assessment work for the year beginning on September 1, 2016. Owner further states that mineral production activities have occurred upon the claims during the last assessment year that would normally qualify as annual assessment work.

Signed

*[Signature]*      8-26-16

SEP 01 2016  
*[Signature]*

RECEIPT # 3647704

8-26-16

Please record this

MDI.

Call me if you have  
any questions.

Thank you,

Pete Myers

2207 Crescent Dr

Dodge City, KS

620-430-3280

67801

PHOENIX, ARIZONA

AUG 30 P 1:59

RECEIVED  
ALMOS STATE OFFICE

Peter Myers  
2207 Gessert Dr.  
Dodge City, KS  
67801

CERTIFIED MAIL

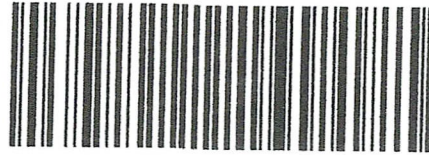

7016 0600 0000 2895 2446



1000



85004

U.S. POSTAGE  
PAID  
DODGE CITY, KS  
67801  
AUG 26, 16  
AMOUNT  
**\$6.47**  
R2305H128754-13

BLM AZ STATE OFFICE

2016 AUG 30 P 1:59

PHOENIX, ARIZONA

Bureau of Land Management  
Arizona St. Office  
One N. Central Ave.  
Phoenix, AZ 85004

8500494427 0041

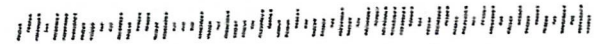

**United States Department of the Interior**  
**Bureau of Land Management**  
 DIV OF LANDS, MINRLS & ENERGY  
 ONE N CENTRAL AVE  
 PHOENIX, AZ 85004 -4427  
 Phone: 602-417-9200

Receipt

No: 3647704

<b>Transaction #:</b> 3751693	
<b>Date of Transaction:</b> 08/31/2016	
CUSTOMER:	
PETER D MYERS 2207 CRESCENT DR DODGE CITY,KS 67801-2827 US	

LINE #	QTY	DESCRIPTION	REMARKS	UNIT PRICE	TOTAL
1	1.00	LOCATABLE MINERALS / MINING CLAIMS- NOT NEW-UNADJUD,ONE AUTH NO. ONLY / MINING CLAIM MONEY RECEIVED CASES: AMC361755/\$1395.00	NOI/MAINT FEE 2017 - 9	- n/a -	1395.00
<b>TOTAL:</b>					<b>\$1,395.00</b>

PAYMENT INFORMATION					
1	AMOUNT:	1395.00	POSTMARKED:	08/26/2016	
	TYPE:	CHECK	RECEIVED:	08/30/2016	
	CHECK NO:	4194			
	NAME:	MYERS, PETER D 2207 CRESCENT DR DODGE CITY KS 67801-2827 US			

REMARKS

This receipt was generated by the automated BLM Collections and Billing System and is a paper representation of a portion of the official electronic record contained therein.



8-26-15  
Amc 361755  
361955  
366532  
383267

B.L.M.,

Please record this "Notice of Intention  
Mining Claims."

RECEIVED  
BLM AZ STATE OFFICE  
2015 AUG 31 4:07  
PHOENIX, ARIZONA

Enclosed \$5,270 for 34 claims

Call if you have any questions. 620-430-3188  
RMM

SEP 12 2015  
RMM

NOTIFIED OF INCORRECT AMC # BY MAIL.  
OCT 15 2015

Notice Of Intention To Hold Mining Claim(s)

This Notice of Intention to Hold Mining Claim(s) is made pursuant to 43 C.F.R., subpart 3833.2.3, by:

Name (owner or agent) P.M. EXPLORATION LLC

Address 2207 CRESCENT DRIVE

City, State, Zip DODGE CITY, KS. 67801

Claim Name	BLM AMC#	Cochise County Recording #
<u>KPD#001</u>	<u>AMC366532</u> <sup>7</sup>	<u>050725415</u> <sup>7</sup>
<u>KPD#004</u>	<u>AMC366533</u>	<u>050725416</u>
<u>KPD#005</u>	<u>AMC366534</u>	<u>050725417</u>
<u>KPD#006</u>	<u>AMC366535</u>	<u>050725418</u>
<u>KPD#008</u>	<u>AMC366536</u>	<u>050725419</u>
<u>KPD#009</u>	<u>AMC366537</u> ]	<u>050725419</u> ]
<u>KPD#010</u>	<u>AMC383267</u> ]	<u>070517894</u> <sup>7</sup>
<u>KPD#011</u>	<u>AMC383268</u> ]	<u>070517895</u> ]

ADDITIONAL CLAIMS ARE LISTED ON ATTACHED SHEET

The above named claim(s) is (are) held claimed by the owner(s) for the valuable mineral contained therein. I (we) intend to continue development of the claim(s).

Annual assessment work or report of geological, geochemical or geophysical survey is not required because the owner has paid a rental fee of \$155.00 per claim for the assessment year ending August 31, 2015 and is paying \$155.00 per claim for an advanced rental fee for the assessment work for the year beginning on September 1, 2015. Owner further states that mineral production activities have occurred upon the claims during the last assessment year that would normally qualify as annual assessment work.

Signed [Signature]

Date 8-26-15

RECEIVED  
BLM A  
OFFICE  
DENIX, ARIZONA  
AUG 31 P 4: 07

RECEIPT # 338 3874

Claim Name	Owner	BLM AMC #	Cochise County Recording #	Claim Type
KPD 012	PM Exploration LLC	366538	050725420	Lode
KPD 015	PM Exploration LLC	366539	050725421	Lode
KPD 016	PM Exploration LLC	366540	050725422	Lode
KPD 017	PM Exploration LLC	366541	050725423	Lode
KPD 018	PM Exploration LLC	366542	050725424	Lode
KPD 019	PM Exploration LLC	366543	050725425	Lode
KPD 020	PM Exploration LLC	366544	050725426	Lode
KPD 021	PM Exploration LLC	366545	050725427	Lode
KPD 022	PM Exploration LLC	366546	050725428	Lode
KPD 023	PM Exploration LLC	366547	050725429	Lode
KPD 024	PM Exploration LLC	366548	050725430	Lode
KPD 025	PM Exploration LLC	366549	050725431	Lode
KPD 026	PM Exploration LLC	366550	050725432	Lode
KPD 027	PM Exploration LLC	366551	050725433	Lode
KPD 029	PM Exploration LLC	383269	050717896	Lode
KPD 030	PM Exploration LLC	383270	050717897	Lode
KPD 034	PM Exploration LLC	366552	050725434	Lode
KPD 035	PM Exploration LLC	366553	050725435	Lode
KPD 043	PM Exploration LLC	366554	050725436	Lode
KPD 048	PM Exploration LLC	366555	050725437	Lode
KPD 057	PM Exploration LLC	366556	050725438	Lode
KPD 060	PM Exploration LLC	366557	050725439	Lode
N.D. 10	PM Exploration LLC	361755	040617412	Lode
N.D. 11	PM Exploration LLC	361756	040617413	Lode
N.D. 12	PM Exploration LLC	361757	040617414	Lode
N.D. 13	PM Exploration LLC	361758	040617415	Lode

361955  
~~361954~~  
361956

*Peter Meyer* 8-26-15

RECEIVED  
BLM AT PHOENIX  
2015 AUG 31 P 4: 07  
PHOENIX, ARIZONA

CERTIFIED MAIL

Pete Myers  
2207 Crescent Dr  
Dodge City, KS



7015 0640 0003 7395 3890



1000

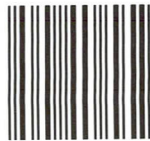

85004

U.S. POSTAGE  
PAID  
DODGE CITY, KS  
67801  
AUG 26, 15  
AMOUNT

**\$6.74**

R2304M115131-11

2015 AUG 31 P 3:58  
PHOENIX, ARIZONA  
**RETURN RECEIPT  
REQUESTED**

BLM  
AZ State Office  
1 North Central Ave, Suite 800  
Phoenix, AZ  
85004

8500494427



**United States Department of the Interior**  
**Bureau of Land Management**  
 LANDS/RECREATION & PLANNING  
 ONE N CENTRAL AVE  
 PHOENIX, AZ 85004 -2203  
 Phone: 602-417-9200

Receipt

No: 3383814

<b>Transaction #:</b> 3482135	
<b>Date of Transaction:</b> 09/01/2015	
CUSTOMER:	
PETER D MYERS 2207 CRESCENT DR DODGE CITY,KS 67801-2827 US	

LINE #	QTY	DESCRIPTION	REMARKS	UNIT PRICE	TOTAL
1	1.00	LOCATABLE MINERALS / MINING CLAIMS-NOT NEW-UNADJUD,ONE AUTH NO. ONLY / MINING CLAIM MONEY RECEIVED CASES: AMC366532/\$5270.00	NOI / MAINT FEE PYMNT - 34 2016	- n/a -	5270.00
<b>TOTAL:</b>					<b>\$5,270.00</b>

PAYMENT INFORMATION			
1	AMOUNT:	5270.00	POSTMARKED: 08/26/2015
	TYPE:	CHECK	RECEIVED: 08/31/2015
	CHECK NO:	3880	
	NAME:	MYERS, PETER D 2207 CRESCENT DR DODGE CITY KS 67801-2827 US	

REMARKS

This receipt was generated by the automated BLM Collections and Billing System and is a paper representation of a portion of the official electronic record contained therein.

ENTERED  
 SEP 02 2015  
 BY: *Ran*

**DEPARTMENT OF THE INTERIOR  
BUREAU OF LAND MANAGEMENT  
MINING CLAIMS**

**MC Customer Information - With Serial No. and Claim Name  
ACTIVE CLAIMS**

Admin State: AZ

Geo State: AZ

**MYERS PETE  
2207 CRESCENT DR  
DODGE CITY, KS 67801-2827**

CUSTOMER ID: 2218402

<u>Serial No.</u>	<u>Claim Name/Number</u>	<u>Lead Serial No.</u>	<u>Disposition</u>
AMC361755	N.D. #10	AMC361755	ACTIVE
AMC361756	N.D. #11	AMC361755	ACTIVE
AMC366532	KPD#001	AMC366532	ACTIVE
AMC366533	KPD#004	AMC366532	ACTIVE
AMC366534	KPD#005	AMC366532	ACTIVE
AMC366535	KPD#006	AMC366532	ACTIVE
AMC366536	KPD#008	AMC366532	ACTIVE
AMC366537	KPD#009	AMC366532	ACTIVE
AMC366538	KPD#012	AMC366532	ACTIVE
AMC366539	KPD#015	AMC366532	ACTIVE
AMC366540	KPD#016	AMC366532	ACTIVE
AMC366541	KPD#017	AMC366532	ACTIVE
AMC366542	KPD#018	AMC366532	ACTIVE
AMC366543	KPD#019	AMC366532	ACTIVE
AMC366544	KPD#020	AMC366532	ACTIVE
AMC366545	KPD#021	AMC366532	ACTIVE
AMC366546	KPD#022	AMC366532	ACTIVE
AMC366547	KPD#023	AMC366532	ACTIVE
AMC366548	KPD#024	AMC366532	ACTIVE
AMC366549	KPD#025	AMC366532	ACTIVE
AMC366550	KPD#026	AMC366532	ACTIVE
AMC366551	KPD#027	AMC366532	ACTIVE
AMC366552	KPD#034	AMC366532	ACTIVE
AMC366553	KPD#035	AMC366532	ACTIVE
AMC366554	KPD#043	AMC366532	ACTIVE
AMC366555	KPD#048	AMC366532	ACTIVE
AMC366556	KPD#057	AMC366532	ACTIVE
AMC366557	KPD#060	AMC366532	ACTIVE
AMC383267	KPD 010	AMC383267	ACTIVE
AMC383268	KPD 011	AMC383267	ACTIVE
AMC383269	KPD 029	AMC383267	ACTIVE
AMC383270	KPD 030	AMC383267	ACTIVE

Number of ACTIVE cases: 32

UNITED STATES DEPARTMENT OF INTERIOR  
BUREAU OF LAND MANAGEMENT

## CLAIM NAME/NUMBER INDEX

County: COCHISE

<u>Claim Name/Number</u>	<u>Serial Number</u>	<u>Claimant(s)</u>	<u>Mer</u>	<u>Tw</u>	<u>Range</u>	<u>Sec</u>	<u>Subdiv</u>	<u>Location Date</u>	<u>Case Closed</u>
N.D. #10	AMC361755	MYERS PETE	14	0230S	0200E	030	SW	05/24/2004	
			14	0230S	0200E	031	NW	05/24/2004	
			14	0230S	0200E	030	SW	05/24/2004	
			14	0230S	0200E	031	NW	05/24/2004	
			14	0230S	0200E	030	SW	05/24/2004	
N.D. #11	AMC361756	MYERS PETE	14	0230S	0200E	030	SW	05/24/2004	
			14	0230S	0200E	031	NW	05/24/2004	
			14	0230S	0200E	030	SW	05/24/2004	
			14	0230S	0200E	031	NW	05/24/2004	
			14	0230S	0200E	030	SW	05/24/2004	
N.D.#12 N.D.#13	AMC361955 AMC361956	P M EXPL LLC	14	0230S	0200E	031	NW	05/24/2004	
			14	0230S	0200E	030	SW	06/23/2004	
			14	0230S	0200E	030	SW	06/23/2004	

361755  
361955  
366532  
383267

8-27-14

B.L.M.,  
Please record this  
for P.M.E.  
Call if you have any  
questions. 620 430 3188

Thanks,  
Pete Meyer

ENTERED  
SEP 03 2014  
BY: fb

RECEIVED  
BLM AZ STATE OFFICE  
2014 AUG 29 P 1:26  
PHOENIX, ARIZONA



Notice Of Intention To Hold Mining Claim(s)

This Notice of Intention to Hold Mining Claim(s) is made pursuant to 43 C.F.R., subpart 3833.2.3, by:

Name (owner or agent) P.M. EXPLORATION LLC

Address 2207 CRESCENT DRIVE

City, State, Zip DODGE CITY, KS. 67801

Claim Name	BLM AMC#	Cochise County Recording #
<u>KPD#001</u>	<u>AMC366532</u>	<u>050725415</u>
<u>KPD#004</u>	<u>AMC366533</u>	<u>050725416</u>
<u>KPD#005</u>	<u>AMC366534</u>	<u>050725417</u>
<u>KPD#006</u>	<u>AMC366535</u>	<u>050725418</u>
<u>KPD#008</u>	<u>AMC366536</u>	<u>050725419</u>
<u>KPD#009</u>	<u>AMC366537</u>	<u>050725419</u>
<u>KPD#010</u>	<u>AMC383267</u>	<u>070517894</u>
<u>KPD#011</u>	<u>AMC383268</u>	<u>070517895</u>

RECEIVED  
 BLM AZ STATE OFFICE  
 2014 AUG 29 P 1:27  
 PHOENIX, ARIZONA

ADDITIONAL CLAIMS ARE LISTED ON ATTACHED SHEET

The above named claim(s) is (are) held claimed by the owner(s) for the valuable mineral contained therein. I (we) intend to continue development of the claim(s).

Annual assessment work or report of geological, geochemical or geophysical survey is not required because the owner has paid a rental fee of \$155.00 per claim for the assessment year ending August 31, 2014 and is paying \$155.00 per claim for an advanced rental fee for the assessment work for the year beginning on September 1, 2014. Owner further states that mineral production activities have occurred upon the claims during the last assessment year that would normally qualify as annual assessment work.

Signed Peter Meyer

Date 8-27-14

NO. OF CLAIMS 34  
 AMOUNT \$5270.00  
 RECEIPT NO. 3119285  
 INIT. Al.A.

\*\* BLM-ASO\*\*

ADDITIONAL CLAIMS FOR P.M. EXPLORATION LLC

Notice of Intention To Hold Mining Claims

Claim Name	BLM AMC#	Cochise Co. Recording #
KPD#012	AMC366538	050725420
KPD#015	AMC366539	050725421
KPD#016	AMC366540	050725422
KPD#017	AMC366541	050725423
KPD#018	AMC366542	050725424
KPD#019	AMC366543	050725425
KPD#020	AMC366544	050725426
KPD#021	AMC366545	050725427
KPD#022	AMC366546	050725428
KPD#023	AMC366547	050725429
KPD#024	AMC366548	050725430
KPD#025	AMC366549	050725431
KPD#026	AMC366550	050725432
KPD#027	AMC366551	050725433
KPD#029	AMC383269	070517896
KPD#030	AMC383270	070517897
KPD#034	AMC366552	050725434
KPD#035	AMC366553	050725435
KPD#043	AMC366554	050725436
KPD#048	AMC366555	050725437
KPD#057	AMC366556	050725438
KPD#060	AMC366557	050725439
N.D.#10	AMC361755	040617412
N.D.#11	AMC361756	040617413
N.D.#12	AMC361955	040620541
N.D.#13	AMC361956	040620540

RECEIVED  
BLM AZ STATE OFFICE  
2014 AUG 29 P 1:27  
PHOENIX, ARIZONA

Signed *Pat Myers*  
Date 8-27-14

ENTERED INTO COMPUTER

Pete Myers  
2207 Crescent Dr.  
Dodge City, KS  
67801

PHOENIX, ARIZONA

2014 AUG 29 P 1:28

RECEIVED  
BLM AZ STATE OFFICE

B.L.M.  
One North Central Ave Suite 800  
Phoenix, AZ 85004-4427

**United States Department of the Interior**  
**Bureau of Land Management**  
 LANDS/RECREATION & PLANNING  
 ONE N CENTRAL AVE  
 PHOENIX, AZ 85004 -2203  
 Phone: 602-417-9200

Receipt

No: 3119285

<b>Transaction #:</b> 3211094	
<b>Date of Transaction:</b> 09/02/2014	
<b>ENTERED INTO COMPUTER</b>	
CUSTOMER:	
PETER D MYERS 2207 CRESCENT DR DODGE CITY,KS 67801-2827 US	SEP - 3 2014 <i>fb</i>

LINE #	QTY	DESCRIPTION	REMARKS	UNIT PRICE	TOTAL
1	1.00	LOCATABLE MINERALS / MINING CLAIMS-NOT NEW-UNADJUD,ONE AUTH NO. ONLY / MINING CLAIM MONEY RECEIVED CASES: AMC366532/\$5270.00	MAINT FEE PYMNT (34)✓ 2015	- n/a -	5270.00
<b>TOTAL:</b>					<b>\$5,270.00</b>

PAYMENT INFORMATION					
1	AMOUNT:	5270.00	POSTMARKED:	08/28/2014	
	TYPE:	CHECK	RECEIVED:	08/29/2014	
	CHECK NO:	3790			
	NAME:	MYERS, PETER D 2207 CRESCENT DR DODGE CITY KS 67801-2827 US			

REMARKS

This receipt was generated by the automated BLM Collections and Billing System and is a paper representation of a portion of the official electronic record contained therein.

Pete Myers  
2207 Crescent Dr.  
Dodge City, KS  
67801

B.L.M.  
One North Central Ave Suite 800  
Phoenix, AZ 85004-4427

RECEIVED  
BLM AZ STATE OFFICE  
2014 AUG 29 P 1:28  
PHOENIX, ARIZONA

PRESS FIRMLY TO SEAL

PRESS FIRMLY TO SEAL

UNITED STATES  
POSTAL SERVICE

1007

U.S. POSTAGE  
PAID  
DODGE CITY, KS  
67801  
AUG 28, 14  
AMOUNT  
**\$19.99**  
00020342-09

# PRIORITY ★ MAIL ★ EXPRESS™

OUR FASTEST SERVICE IN THE U.S.

RECEIVED  
BLM AZ STATE OFFICE  
2014 AUG 29 P 1:2  
PHOENIX, ARIZONA

WHEN USED INTERNATIONALLY,  
A CUSTOMS DECLARATION  
LABEL MAY BE REQUIRED.



EP13F July 2013 OD: 12.5 x 9.5



PS 1000100006

VISIT US AT [USPS.COM](http://USPS.COM)®  
ORDER FREE SUPPLIES ONLINE



E K 3 4 2 2 5 1 1 9 2 U S

NATIONAL IISF



PRIORITY  
★ MAIL ★  
EXPRESS™

**CUSTOMER USE ONLY**

FROM: (PLEASE PRINT) PHONE (620) 430 3188  
 Pete Myers  
 2207 Crescent Dr  
 Dodge City, KS 67801

PAYMENT BY ACCOUNT (if applicable)

**DELIVERY OPTIONS (Customer Use Only)**

SIGNATURE REQUIRED Note: The mailer must check the "Signature Required" box if the mailer: 1) Requires the addressee's signature; OR 2) Purchases additional insurance; OR 3) Purchases COD service; OR 4) Purchases Return Receipt service. If the box is not checked, the Postal Service will leave the item in the addressee's mail receptacle or other secure location without attempting to obtain the addressee's signature on delivery.

**Delivery Options**

No Saturday Delivery (delivered next business day)  
 Sunday/Holiday Delivery Required (additional fee, where available)  
 10:30 AM Delivery Required (additional fee, where available)  
 \*Refer to USPS.com® or local Post Office™ for availability.

TO: (PLEASE PRINT) PHONE ( )  
 B.L.M.  
 One North Central Ave Suite 300  
 Phoenix, AZ

ZIP + 4® (U.S. ADDRESSES ONLY)  
 85004-4427

WRITE FIRMLY TO MAKE ALL COPIES LEGIBLE.

**ORIGIN (POSTAL SERVICE USE ONLY)**

1-Day  2-Day  Military  GPO

PG ZIP Code: 67801 Scheduled Delivery Date (MMDDYY): 8/28/14  
 Postage: \$ 19.99

Date Accepted (MMDDYY): 8/28/14 Scheduled Delivery Time:  
 10:30 AM  3:00 PM  
 12 NOON

Time Accepted:  
 AM  PM  
 10:30 AM Delivery Fee: \$ Return Receipt Fee: \$ Live Animal Transportation Fee: \$

Weight:  Flat Rate  Sunday/Holiday Premium Fee: \$ Total Postage & Fees: \$ 19.99  
 lbs. ozs. Acceptance Employee Initials: [Signature]

**DELIVERY (POSTAL SERVICE USE ONLY)**

Delivery Attempt (MMDDYY) Time Employee Signature  
 AM  PM

Delivery Attempt (MMDDYY) Time Employee Signature  
 AM  PM

LABEL 11-B, JANUARY 2014

PSN 7690-02-000-9996

3-ADDRESSEE COPY



UNITED STATES  
POSTAL SERVICE

This packaging is the property of the U.S. Postal Service® and is provided solely for use in sending Priority Mail Express™ shipments. Misuse may be a violation of federal law. This packaging is not for resale. EP13F © U.S. Postal Service, July 2013; All rights reserved.

This envelope is made from post-consumer waste. Please recycle - again.

Amc366532  
383267  
361755  
361955

Notice Of Intention To Hold Mining Claim(s)

This Notice of Intention to Hold Mining Claim(s) is made pursuant to 43 C.F.R., subpart 3833.2.3, by:

Name (owner or agent) P.M. EXPLORATION LLC

Address 2207 CRESCENT DRIVE

City, State, Zip DODGE CITY, KS. 67801

Claim Name	BLM AMC#	Cochise County Recording #
<u>KPD#001</u>	<u>AMC366532</u>	<u>050725415</u>
<u>KPD#004</u>	<u>AMC366533</u>	<u>050725416</u>
<u>KPD#005</u>	<u>AMC366534</u>	<u>050725417</u>
<u>KPD#006</u>	<u>AMC366535</u>	<u>050725418</u>
<u>KPD#008</u>	<u>AMC366536</u>	<u>050725419</u>
<u>KPD#009</u>	<u>AMC366537</u>	<u>050725419</u>
<u>KPD#010</u>	<u>AMC383267</u>	<u>070517894</u>
<u>KPD#011</u>	<u>AMC383268</u>	<u>070517895</u>

ADDITIONAL CLAIMS ARE LISTED ON ATTACHED SHEET

The above named claim(s) is (are) held claimed by the owner(s) for the valuable mineral contained therein. I (we) intend to continue development of the claim(s).

Annual assessment work or report of geological, geochemical or geophysical survey is not required because the owner has paid a rental fee of \$140.00 per claim for the assessment year ending August 31, 2013 and is paying \$140.00 per claim for an advanced rental fee for the assessment work for the year beginning on September 1, 2013. Owner further states that mineral production activities have occurred upon the claims during the last assessment year that would normally qualify as annual assessment work.

Signed [Signature]

Date 8-27-13

ENTERED  
SEP 09 2013  
BY: TS

NO. OF CLAIMS 34  
AMOUNT \$4760.00  
RECEIPT NO. 2069918  
NIT. [Signature]

RECEIVED  
BLM AT STATE OFFICE  
AUG 29 10:09 AM  
ARIZONA

ADDITIONAL CLAIMS FOR P.M. EXPLORATION LLC

Notice of Intention to Hold Mining Claims

Claim Name	BLM AMC#	Cochise Co. Recording #
KPD#012	AMC366538	050725420
KPD#015	AMC366539	050725421
KPD#016	AMC366540	050725422
KPD#017	AMC366541	050725423
KPD#018	AMC366542	050725424
KPD#019	AMC366543	050725425
KPD#020	AMC366544	050725426
KPD#021	AMC366545	050725427
KPD#022	AMC366546	050725428
KPD#023	AMC366547	050725429
KPD#024	AMC366548	050725430
KPD#025	AMC366549	050725431
KPD#026	AMC366550	050725432
KPD#027	AMC366551	050725433
KPD#029	AMC383269	070517896
KPD#030	AMC383270	070517897
KPD#034	AMC366552	050725434
KPD#035	AMC366553	050725435
KPD#043	AMC366554	050725436
KPD#048	AMC366555	050725437
KPD#057	AMC366556	050725438
KPD#060	AMC366557	050725439
N.D.#10	AMC361755	040617412
N.D.#11	AMC361756	040617413
N.D.#12	AMC361955	040620541
N.D.#13	AMC361956	040620540

Signed

*Peter M. ...*

Date

8-27-13

PHOENIX, ARIZONA

2013 AUG 29 A 10:09

RECEIVED  
BLM AZ STATE OFFICE



**United States Department of the Interior**  
**Bureau of Land Management**  
 LANDS/RECREATION & PLANNING  
 ONE N CENTRAL AVE  
 PHOENIX, AZ 85004 -2203  
 Phone: 602-417-9200

Receipt

No: 2869918

<b>Transaction #:</b> 2955889	
<b>Date of Transaction:</b> 08/30/2013	
CUSTOMER:	
	PETER D MYERS 2207 CRESCENT DR DODGE CITY,KS 67801-2827 US

LINE #	QTY	DESCRIPTION	REMARKS	UNIT PRICE	TOTAL
1	1.00	LOCATABLE MINERALS / MINING CLAIMS-NOT NEW-UNADJUD,ONE AUTH NO. ONLY / MINING CLAIM MONEY RECEIVED <b>CASES: AMC366532/\$4760.00</b>	MAINT FEE PYMNT (34) 2014 / NOI (34) 2013	- n/a -	4760.00
<b>TOTAL:</b>					<b>\$4,760.00</b>

PAYMENT INFORMATION			
1	AMOUNT:	4760.00	POSTMARKED: 08/28/2013
	TYPE:	CHECK	RECEIVED: 08/29/2013
	CHECK NO:	3417	
	NAME:	MYERS, PETER D 2207 CRESCENT DR DODGE CITY KS 67801-2827 US	

REMARKS

This receipt was generated by the automated BLM Collections and Billing System and is a paper representation of a portion of the official electronic record contained therein.

DECONCINI MCDONALD YETWIN & LACY

A PROFESSIONAL CORPORATION  
ATTORNEYS AT LAW

ROBIN E. BARNES, CP  
rbarnes@dmyl.com

2525 EAST BROADWAY BOULEVARD • SUITE 200  
TUCSON, ARIZONA 85716-5300  
(520) 322-5000 • (520) 322-5585 (Fax)

WWW.DECONCINIMCDONALD.COM

AMC 366532  
383267  
361755

August 23, 2012 361955  
401295  
406091

Via Federal Express

Arizona State Office  
Bureau of Land Management  
Attention: Public Room  
One North Central Avenue, Suite 800  
Phoenix, AZ 85004-4427

RECEIVED  
BLM AZ STATE OFFICE  
2012 AUG 24 A 9:58  
PHOENIX, ARIZONA

RE: **Payment of Claim Maintenance Fee; P.M. Exploration, LLC.**

Ladies and Gentlemen:

Delivered herewith is a check in the amount of \$14,000.00 as payment of the claim maintenance fees pursuant to the 30 U.S.C. § 28f(a), as adjusted by 30 U.S.C. § 28j(c) and implemented by notice in 74 *Federal Register* 30959-62 (June 29, 2009) and as amended by the Consolidated Appropriations Act 2012, Pub. L. No. 112-74, 125 Stat. 786 (2011). The owner has paid a maintenance fee of \$140 per for the assessment year beginning September 1, 2012. A copy of the Certification of Payment of Maintenance Fee in Lieu of Affidavit of Annual Assessment Work to be recorded with the Cochise County Recorder's Office is also enclosed herewith.

Please return a date-stamped copy of this letter and the affidavit along with the receipt for payment to this office.

Thank you for your assistance and please feel free to contact me or John Lacy with any questions or concerns.

Sincerely,



Robin E. Barnes, CP  
Certified Paralegal

reb  
Enc.  
c. w/out enc. Peter Rees (via email)

NO. OF CLAIMS 100  
AMOUNT 14000.00  
RECEIPT NO. 2640796  
INIT. R.E.

I:\FILES\DOCS\STRA14\110776\LTR\MV1908.DOCX

ENTERED INTO COMPUTER

9/6/12 AT

From: (520) 322-5000  
Lu Ann Corliss  
DeConcini Law Firm  
2525 East Broadway  
Suite 200  
Tucson, AZ 85716

Origin ID: TUSA



Ship Date: 23AUG12  
ActWgt: 1.0 LB  
CAD: 5333594/INET3300

Delivery Address Bar Code



SHIP TO: (520) 322-5000

BILL SENDER

Arizona State Office  
Bureau of Land Management  
One North Central Ave., #800  
Attn: Public Room  
Phoenix, AZ 85004

Ref # 291366/110776/120165/251031/RB  
Invoice #  
PO #  
Dept #

FRI - 24 AUG A1  
PRIORITY OVERNIGHT

TRK# 7988 1472 2949

0201

85004  
AZ-US  
PHX

XH ZSYA

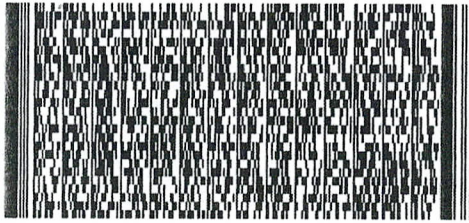

515G20C34/AA44

After printing this label

1. Use the "Print" button on this page to print your label to your laser or inkjet printer.
2. Fold the printed page along the horizontal line.
3. Place label in shipping pouch and affix it to your shipment so that the barcode portion of the label can be read and scanned.

**Warning:** Use only the printed original label for shipping. Using a photocopy of this label for shipping purposes is fraudulent and could result in additional billing charges, along with the cancellation of your FedEx account number.

Use of this system constitutes your agreement to the service conditions in the current FedEx Service Guide, available on [fedex.com](http://fedex.com). FedEx will not be responsible for any claim in excess of \$100 per package, whether the result of loss, damage, delay, non-delivery, misdelivery, or misinformation, unless you declare a higher value, pay an additional charge, document your actual loss and file a timely claim. Limitations found in the current FedEx Service Guide apply. Your right to recover from FedEx for any loss, including intrinsic value of the package, loss of sales, income interest, profit, attorney's fees, costs, and other forms of damage whether direct, incidental, consequential, or special is limited to the greater of \$100 or the authorized declared value. Recovery cannot exceed actual documented loss. Maximum for items of extraordinary value is \$500, e.g. jewelry, precious metals, negotiable instruments and other items listed in our Service Guide. Written claims must be filed within strict time limits, see current FedEx Service Guide.

PHOENIX, ARIZONA

2012 AUG 24 A 9:58

RECEIVED  
BLMAZ STATE OFFICE

After recording, please return to:  
Marian C. LaLonde  
DeConcini McDonald Yetwin & Lacy, P.C.  
2525 E. Broadway Blvd., #200  
Tucson, AZ 85716

RECEIVED  
BLM AZ STATE OFFICE  
2012 AUG 24 A 9:58  
PIMA COUNTY, ARIZONA

STATE OF ARIZONA.        )  
                                          ) ss:  
County of Pima                )

CERTIFICATION OF PAYMENT OF MAINTENANCE FEE  
IN LIEU OF AFFIDAVIT OF ANNUAL ASSESSMENT WORK

Marian C. LaLonde, being first duly sworn, deposes and says that:

1. She is an agent for P.M. Exploration, LLC, a Kansas limited liability company, the owner of the unpatented lode mining claims situated in Cochise County, Arizona (the "Claims"), the location notices of which are of record in Cochise County, and in the records of the Arizona State Office of the Bureau of Land Management under the file numbers indicated in the attached Exhibit A. The Claims are situated in Sections 25 and 36, Township 23 South, Range 19 East, Sections 1, Township 24 South, Range 19 East, Sections 30, 31, and 32, Township 23 South, Range 20 East, and Sections 5, 6, and 7, Township 24 South, Range 20 East, G&SR Mer.

2. Pursuant to the 30 U.S.C. § 28f(a), as adjusted by 30 U.S.C. § 28j(c) and implemented by notice in 74 *Federal Register* 30959-62 (June 29, 2009) and as amended by the Consolidated Appropriations Act 2012, Pub. L. No. 112-74, 125 Stat. 786 (2011), the owner has paid a maintenance fee of \$140 per for the assessment year beginning September 1, 2012. This Certificate is in lieu of an affidavit of performance of annual assessment work or notice of intent to hold.

3. The name and address of the owner of the Claims for which this Certificate is prepared are P.M. Exploration, LLC, 2207 Crescent Dr., Dodge City, KS 67801. THIS IS NOT A CHANGE OF ADDRESS

4. The Claims are held and claimed by the owner for the valuable minerals contained therein.

DATED this 23<sup>rd</sup> day of August, 2012.

  
Marian C. LaLonde, Agent

Sworn and subscribed before me this 23<sup>rd</sup> day of August, 2012, by Marian C. LaLonde, agent for P.M. Exploration, LLC.

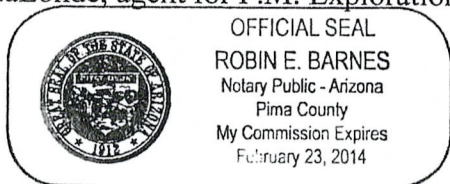

  
Notary Public

EXHIBIT A

CLAIM NAME	OWNER NAME	BLM AMC NO.	COCHISE COUNTY RECORDING INFO.
KPD #001	PM Exploration LLC	366532	2005-25415
KPD #004	PM Exploration LLC	366533	2005-25416
KPD #005	PM Exploration LLC	366534	2005-25417
KPD #006	PM Exploration LLC	366535	2005-25418
KPD #008	PM Exploration LLC	366536	2005-25419
KPD #009	PM Exploration LLC	366537	2005-25420
KPD 010	PM Exploration LLC	383267	2007-17894
KPD 011	PM Exploration LLC	383268	2007-17895
KPD #012	PM Exploration LLC	366538	2005-25421
KPD #015	PM Exploration LLC	366539	2005-25422
KPD #016	PM Exploration LLC	366540	2005-25423
KPD #017	PM Exploration LLC	366541	2005-25424
KPD #018	PM Exploration LLC	366542	2005-25425
KPD #019	PM Exploration LLC	366543	2005-25426
KPD #020	PM Exploration LLC	366544	2005-25427
KPD #021	PM Exploration LLC	366545	2005-25428
KPD #022	PM Exploration LLC	366546	2005-25429
KPD #023	PM Exploration LLC	366547	2005-25430
KPD #024	PM Exploration LLC	366548	2005-25431
KPD #025	PM Exploration LLC	366549	2005-25432
KPD #026	PM Exploration LLC	366550	2005-25433
KPD #027	PM Exploration LLC	366551	2005-25434
KPD #029	PM Exploration LLC	383269	2007-17896
KPD #030	PM Exploration LLC	383270	2007-17897
KPD #034	PM Exploration LLC	366552	2005-25435
KPD #035	PM Exploration LLC	366553	2005-25436
KPD #043	PM Exploration LLC	366554	2005-25437
KPD #048	PM Exploration LLC	366555	2005-25438
KPD #057	PM Exploration LLC	366556	2005-25439
KPD #060	PM Exploration LLC	366557	2005-25440
N.D. #10	PM Exploration LLC	361755	2004-17412
N.D. #11	PM Exploration LLC	361756	2004-17413
N.D. #12	PM Exploration LLC	361955	2004-20541
N.D. #13	PM Exploration LLC	361956	2004-20440
KPD 028	PM Exploration LLC	401295	2010-14424
KPD 036	PM Exploration LLC	401296	2010-14432
KPD 037	PM Exploration LLC	401297	2010-14425
KPD 038	PM Exploration LLC	401298	2010-14417
KPD 039	PM Exploration LLC	401299	2010-14418
KPD 040	PM Exploration LLC	401300	2010-14426
KPD 041	PM Exploration LLC	401301	2010-14433
KPD 042	PM Exploration LLC	401302	2010-14439

PHOENIX, ARIZONA

RECEIVED  
 BLM AZ STATE OFFICE  
 2012 AUG 24 A 9:58

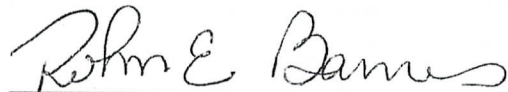
KPD 049	PM Exploration LLC	401303	2010-14440
KPD 050	PM Exploration LLC	401304	2010-14434
KPD 051	PM Exploration LLC	401305	2010-14427
KPD 052	PM Exploration LLC	401306	2010-14419
KPD 053	PM Exploration LLC	401307	2010-14420
KPD 054	PM Exploration LLC	401308	2010-14428
KPD 055	PM Exploration LLC	401309	2010-14435
KPD 056	PM Exploration LLC	401310	2010-14441
KPD 061	PM Exploration LLC	401311	2010-14442
KPD 062	PM Exploration LLC	401312	2010-14436
KPD 063	PM Exploration LLC	401313	2010-14429
KPD 064	PM Exploration LLC	401314	2010-14421
KPD 065	PM Exploration LLC	401315	2010-14437
KPD 066	PM Exploration LLC	401316	2010-14443
KPD 071	PM Exploration LLC	401317	2010-14444
KPD 072	PM Exploration LLC	401318	2010-14438
KPD 073	PM Exploration LLC	401319	2010-14430
KPD 074	PM Exploration LLC	401320	2010-14422
KPD 075	PM Exploration LLC	401321	2010-14423
KPD 076	PM Exploration LLC	401322	2010-14431
Cu 1	PM Exploration LLC	406091	2011-02393
Cu 2	PM Exploration LLC	406092	2011-02394
Cu 3	PM Exploration LLC	406093	2011-03975
Cu 4	PM Exploration LLC	406094	2011-03976
Cu 5	PM Exploration LLC	406095	2011-03977
Cu 6	PM Exploration LLC	406096	2011-03978
Cu 7	PM Exploration LLC	406097	2011-03979
Cu 8	PM Exploration LLC	406098	2011-03980
Cu 9	PM Exploration LLC	406099	2011-03981
Cu 10	PM Exploration LLC	406100	2011-03982
Cu 19	PM Exploration LLC	406109	2011-03991
Cu 20	PM Exploration LLC	406110	2011-03992
Cu 21	PM Exploration LLC	406111	2011-03993
Cu 22	PM Exploration LLC	406112	2011-03994
Cu 23	PM Exploration LLC	406113	2011-03995
Cu 24	PM Exploration LLC	406114	2011-03996
Cu 25	PM Exploration LLC	406115	2011-03997
Cu 26	PM Exploration LLC	406116	2011-03998
Cu 27	PM Exploration LLC	406117	2011-03999
Cu 41	PM Exploration LLC	406131	2011-04013
Cu 42	PM Exploration LLC	406132	2011-04014
Cu 43	PM Exploration LLC	406133	2011-04015
Cu 44	PM Exploration LLC	406134	2011-04016
Cu 45	PM Exploration LLC	406135	2011-04017
Cu 46	PM Exploration LLC	406136	2011-04018
Cu 47	PM Exploration LLC	406137	2011-04019
Cu 48	PM Exploration LLC	406138	2011-04020

PHOENIX, ARIZONA

2012 AUG 24 A 9:58

RECEIVED  
BLM AZ STATE OFFICE

Cu 49	PM Exploration LLC	406139	2011-04021
Cu 50	PM Exploration LLC	406140	2011-04022
Cu 67	PM Exploration LLC	406157	2011-04039
Cu 68	PM Exploration LLC	406158	2011-04040
Cu 69	PM Exploration LLC	406159	2011-04041
Cu 70	PM Exploration LLC	406160	2011-04042
Cu 71	PM Exploration LLC	406161	2011-04043
Cu 72	PM Exploration LLC	406162	2011-04044
Cu 73	PM Exploration LLC	406163	2011-04045
Cu 74	PM Exploration LLC	406164	2011-04046
Cu 161	PM Exploration LLC	406251	2011-04123

I:\FILES\DOCS\STRA14\110776\DOC\MV1654.DOC

PHOENIX, ARIZONA

2012 AUG 24 A 9:58

RECEIVED  
BLM AZ STATE OFFICE



Extremely Urgent

FedEx Ship Manager - Print Your Label(s)

Page 1 of 1

From: (520) 322-5000  
Lu Ann Corliss  
DeConcini Law Firm  
2125 East Broadway  
Suite 200  
Tucson, AZ 85716

Origin ID: TUSA



J12201207160325

Ship Date: 23AUG12  
ActWgt: 1.0 LB  
CAD: 5333594/INET3300

Delivery Address Bar Code



SHIP TO: (520) 322-5000  
Arizona State Office  
Bureau of Land Management  
One North Central Ave., #800  
Attn: Public Room  
Phoenix, AZ 85004

BILL SENDER

Ref# 291366/110776/120165/251031/RB  
Invoice #  
PO #  
Dept #

FRI - 23 AUG A1  
PRIORITY OVERNIGHT

TRK# 7988 1472 2949  
0201

XH ZSYA

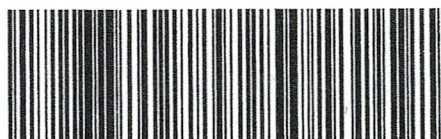

S15G2DC34PA44

RECEIVED  
BLM AZ STATE OFFICE

PHOENIX, ARIZONA  
23 AUG 24  
85004  
AZ-US  
PHX

Comments Only

Use with the container and terms and conditions and the applicable FedEx Service and the current FedEx Service Agreement.

For Express services, always go to [fedex.com](http://fedex.com), for the correct location.

Insert shipping document here.

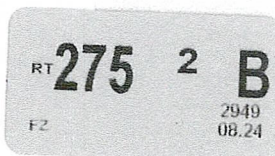



**United States Department of the Interior**  
**Bureau of Land Management**  
 LANDS/RECREATION & PLANNING  
 ONE N CENTRAL AVE  
 PHOENIX, AZ 85004 -2203  
 Phone: 602-417-9200

Receipt

No: 2640796

Transaction #: 2721427	<b>ENTERED INTO COMPUTER</b>
Date of Transaction: 08/27/2012	
CUSTOMER:	
DECONCINI MCDONALD YETWIN & LACY 2525 E BROADWAY BLVD STE 200 TUCSON, AZ 85716-5300 US	

LINE #	QTY	DESCRIPTION	REMARKS	UNIT PRICE	TOTAL
1	1.00	LOCATABLE MINERALS / MINING CLAIMS-NOT NEW-UNADJUD, ONE AUTH NO. ONLY / MINING CLAIM MONEY RECEIVED <b>CASES: AMC366532/\$14000.00</b>	MAINT FEE PYMNT (100) 2013	- n/a -	14000.00
<b>TOTAL:</b>					<b>\$14,000.00</b>

PAYMENT INFORMATION			
1	AMOUNT:	14000.00	POSTMARKED: N/A
	TYPE:	CHECK	RECEIVED: 08/27/2012
	CHECK NO:	047398	
	NAME:	DECONCINI MCDONALD YETWIN & LACY 2525 E BROADWAY BLVD STE 200 TUCSON AZ 85716-5300 US	

REMARKS

This receipt was generated by the automated BLM Collections and Billing System and is a paper representation of a portion of the official electronic record contained therein. *Lead File #'s (PB)*

*Amc 366532  
 383267  
 361755  
 361955  
 401295  
 406091*

DECONCINI McDONALD YETWIN & LACY

A PROFESSIONAL CORPORATION  
ATTORNEYS AT LAW

ROBIN E. BARNES, CP  
rbarnes@dmyl.com

Amc 366532  
Amc 383267  
Amc 361755  
Amc 361955  
2525 EAST BROADWAY BOULEVARD • SUITE 200  
TUCSON, ARIZONA 85716-5300  
(520) 322-5000 • (520) 322-5585 (Fax)  
WWW.DECONCINIMCDONALD.COM

August 1, 2011

Amc 401295  
Amc 406091

**Via Federal Express**

Arizona State Office  
Bureau of Land Management  
Attention: Public Room  
One North Central Avenue, Suite 800  
Phoenix, AZ 85004-4427

RECEIVED  
BLM AZ STATE OFFICE  
2011 AUG - 3 A 7:45  
PHOENIX, ARIZONA

RE: **Payment of Claim Maintenance Fee; P.M. Exploration, LLC**

Ladies and Gentlemen:

Delivered herewith is a check in the amount of \$38,360.00 as payment of the claim maintenance fees pursuant to 30 U.S.C. § 28f(a), as adjusted by 30 U.S.C. § 28j(c) and implemented by notice in 74 *Federal Register* 30959-62 (June 29, 2009), for the assessment year beginning September 1, 2011. A copy of the Certification of Payment of Maintenance Fee in Lieu of Affidavit of Annual Assessment Work to be recorded with the Cochise County Recorder's Office is also enclosed herewith.

Please return a date-stamped copy of this letter and the affidavit along with the receipt for payment to this office. Thank you for your assistance and please feel free to contact me or Marian LaLonde with any questions or concerns

Sincerely,



Robin E. Barnes, CP  
Certified Paralegal

reb

c. w/enc. Peter Rees (via email)  
Bernie Zinkhofer' (via email)  
Richard Simpson (via email)  
Pete Myers (via email)

F:\FILES\DOCS\STRA14\110776\LTR\LM9397.DOC

NO. OF CLAIMS 274  
AMOUNT 38360.00  
RECEIPT NO. 2396009  
INIT. SPJ  
\*\* BLM-ASO \*\*

AUG 5 2011 am

Tucson

Phoenix

Flagstaff

Scottsdale

Alexandria, VA

After recording, please return to:  
Marian C. LaLonde  
DeConcini McDonald Yetwin & Lacy, P.C.  
2525 E. Broadway Blvd., #200  
Tucson, AZ 85716

RECEIVED  
BLM AZ STATE OFFICE

2011 AUG - 3 A 7 46

PIMA COUNTY, ARIZONA

STATE OF ARIZONA            )  
                                          ) ss:  
County of Pima                )

CERTIFICATION OF PAYMENT OF MAINTENANCE FEE  
IN LIEU OF AFFIDAVIT OF ANNUAL ASSESSMENT WORK

Marian C. LaLonde, being first duly sworn, deposes and says that:

1. She is an agent for C.M. Meteor Resources, Ltd., the Lessee of the unpatented lode mining claims situated in Cochise County, Arizona (the "Claims"), the location notices of which are of record in Cochise County, and in the records of the Arizona State Office of the Bureau of Land Management under the file numbers indicated in the attached Exhibit A. The Claims are situated in Sections 25 and 36, Township 23 South, Range 19 East, Sections 1, 12 and 13, Township 24 South, Range 19 East, Sections 30, 31, 32 and 33, Township 23 South, Range 20 East, and Sections 4, 5, 6, 7, 8, 9, 16, 17 and 18, Township 24 South, Range 20 East, G&SR Mer.

2. Pursuant to the 30 U.S.C. § 28f(a), as adjusted by 30 U.S.C. § 28j(c) and implemented by notice in 74 *Federal Register* 30959-62 (June 29, 2009), the owner has paid a maintenance fee of \$140 per claim for the assessment year beginning September 1, 2011. This Certificate is in lieu of an affidavit of performance of annual assessment work or notice of intent to hold.

3. The name and address of the owner of the Claims for which this Certificate is prepared are P.M. Exploration, LLC, 2207 Crescent Dr., Dodge City, KS 67801. THIS IS NOT A CHANGE OF ADDRESS

4. The Claims are held and claimed by the owner for the valuable minerals contained therein.

DATED this 1<sup>st</sup> day of August, 2011.

  
Marian C. LaLonde

Sworn and subscribed before me this 1<sup>st</sup> day of August, 2011, by Marian C. LaLonde, agent for C.M. Meteor Resources, Ltd.

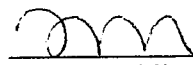
  
Notary Public

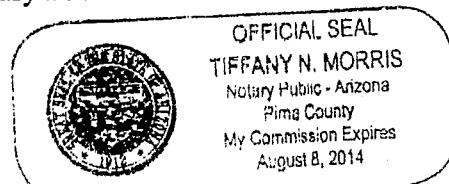

Claim Name	Owner	BLM AMC #	Cochise County Recording #	Claim Type
<b>Original Claims</b>				
KPD #001	PM Exploration LLC	366532	2005-25415	Lode
KPD #004	PM Exploration LLC	366533	2005-25416	Lode
KPD #005	PM Exploration LLC	366534	2005-25417	Lode
KPD #006	PM Exploration LLC	366535	2005-25418	Lode
KPD #008	PM Exploration LLC	366536	2005-25419	Lode
KPD #009	PM Exploration LLC	✓366537	2005-25420	Lode
KPD 010	PM Exploration LLC	383267	2007-17894	Lode
KPD 011	PM Exploration LLC	✓383268	2007-17895	Lode
KPD #012	PM Exploration LLC	366538	2005-25421	Lode
KPD #015	PM Exploration LLC	366539	2005-25422	Lode
KPD #016	PM Exploration LLC	366540	2005-25423	Lode
KPD #017	PM Exploration LLC	366541	2005-25424	Lode
KPD #018	PM Exploration LLC	366542	2005-25425	Lode
KPD #019	PM Exploration LLC	366543	2005-25426	Lode
KPD #020	PM Exploration LLC	366544	2005-25427	Lode
KPD #021	PM Exploration LLC	366545	2005-25428	Lode
KPD #022	PM Exploration LLC	366546	2005-25429	Lode
KPD #023	PM Exploration LLC	366547	2005-25430	Lode
KPD #024	PM Exploration LLC	366548	2005-25431	Lode
KPD #025	PM Exploration LLC	366549	2005-25432	Lode
KPD #026	PM Exploration LLC	366550	2005-25433	Lode
KPD #027	PM Exploration LLC	✓366551	2005-25434	Lode
KPD #029	PM Exploration LLC	383269	2007-17896	Lode
KPD #030	PM Exploration LLC	✓383270	2007-17897	Lode
KPD #034	PM Exploration LLC	366552	2005-25435	Lode
KPD #035	PM Exploration LLC	366553	2005-25436	Lode
KPD #043	PM Exploration LLC	366554	2005-25437	Lode
KPD #048	PM Exploration LLC	366555	2005-25438	Lode
KPD #057	PM Exploration LLC	366556	2005-25439	Lode
KPD #060	PM Exploration LLC	✓366557	2005-25440	Lode
N.D. #10	PM Exploration LLC	361755	2004-17412	Lode
N.D. #11	PM Exploration LLC	✓361756	2004-17413	Lode
N.D. #12	PM Exploration LLC	361955	2004-20541	Lode
N.D. #13	PM Exploration LLC	✓361956	2004-20440	Lode

**Claims added in**

**2010**

KPD #028	PM Exploration LLC	401295	2010-14424	Lode
KPD #036	PM Exploration LLC	401296	2010-14432	Lode
KPD #037	PM Exploration LLC	401297	2010-14425	Lode
KPD #038	PM Exploration LLC	401298	2010-14417	Lode
KPD #039	PM Exploration LLC	401299	2010-14418	Lode
KPD #040	PM Exploration LLC	401300	2010-14426	Lode
KPD #041	PM Exploration LLC	401301	2010-14433	Lode

RECEIVED  
 BLM AZ STATE OFFICE  
 2011 AUG - 3 A 7:46  
 PHOENIX, ARIZONA

KPD #042	PM Exploration LLC	401302	2010-14439	Lode
KPD #049	PM Exploration LLC	401303	2010-14440	Lode
KPD #050	PM Exploration LLC	401304	2010-14434	Lode
KPD #051	PM Exploration LLC	401305	2010-14427	Lode
KPD #052	PM Exploration LLC	401306	2010-14419	Lode
KPD #053	PM Exploration LLC	401307	2010-14420	Lode
KPD #054	PM Exploration LLC	401308	2010-14428	Lode
KPD #055	PM Exploration LLC	401309	2010-14435	Lode
KPD #056	PM Exploration LLC	401310	2010-14441	Lode
KPD #061	PM Exploration LLC	401311	2010-14442	Lode
KPD #062	PM Exploration LLC	401312	2010-14436	Lode
KPD #063	PM Exploration LLC	401313	2010-14429	Lode
KPD #064	PM Exploration LLC	401314	2010-14421	Lode
KPD #065	PM Exploration LLC	401315	2010-14437	Lode
KPD #066	PM Exploration LLC	401316	2010-14443	Lode
KPD #071	PM Exploration LLC	401317	2010-14444	Lode
KPD #072	PM Exploration LLC	401318	2010-14438	Lode
KPD #073	PM Exploration LLC	401319	2010-14430	Lode
KPD #074	PM Exploration LLC	401320	2010-14422	Lode
KPD #075	PM Exploration LLC	401321	2010-14423	Lode
KPD #076	PM Exploration LLC	✓401322	2010-14431	Lode

**CU Claims – acquired 2011**

Cu 1	PM Exploration LLC	406091	2011-02393	Lode
Cu 2	PM Exploration LLC	406092	2011-02394	Lode
Cu 3	PM Exploration LLC	406093	2011-03975	Lode
Cu 4	PM Exploration LLC	406094	2011-03976	Lode
Cu 5	PM Exploration LLC	406095	2011-03977	Lode
Cu 6	PM Exploration LLC	406096	2011-03978	Lode
Cu 7	PM Exploration LLC	406097	2011-03979	Lode
Cu 8	PM Exploration LLC	406098	2011-03980	Lode
Cu 9	PM Exploration LLC	406099	2011-03981	Lode
Cu 10	PM Exploration LLC	406100	2011-03982	Lode
Cu 11	PM Exploration LLC	406101	2011-03983	Lode
Cu 12	PM Exploration LLC	406102	2011-03984	Lode
Cu 13	PM Exploration LLC	406103	2011-03985	Lode
Cu 14	PM Exploration LLC	406104	2011-03986	Lode
Cu 15	PM Exploration LLC	406105	2011-03987	Lode
Cu 16	PM Exploration LLC	406106	2011-03988	Lode
Cu 17	PM Exploration LLC	406107	2011-03989	Lode
Cu 18	PM Exploration LLC	406108	2011-03990	Lode
Cu 19	PM Exploration LLC	406109	2011-03991	Lode
Cu 20	PM Exploration LLC	406110	2011-03992	Lode
Cu 21	PM Exploration LLC	406111	2011-03993	Lode
Cu 22	PM Exploration LLC	406112	2011-03994	Lode
Cu 23	PM Exploration LLC	✓406113	2011-03995	Lode

PIQUEUX, ARIZONA

2011 AUG - 3 A 7 46

RECEIVED  
BLM AZ STATE OFFICE

Cu 24	PM Exploration LLC	406114	2011-03996	Lode
Cu 25	PM Exploration LLC	406115	2011-03997	Lode
Cu 26	PM Exploration LLC	406116	2011-03998	Lode
Cu 27	PM Exploration LLC	406117	2011-03999	Lode
Cu 28	PM Exploration LLC	406118	2011-04000	Lode
Cu 29	PM Exploration LLC	406119	2011-04001	Lode
Cu 30	PM Exploration LLC	406120	2011-04002	Lode
Cu 31	PM Exploration LLC	406121	2011-04003	Lode
Cu 32	PM Exploration LLC	406122	2011-04004	Lode
Cu 33	PM Exploration LLC	406123	2011-04005	Lode
Cu 34	PM Exploration LLC	406124	2011-04006	Lode
Cu 35	PM Exploration LLC	406125	2011-04007	Lode
Cu 36	PM Exploration LLC	406126	2011-04008	Lode
Cu 37	PM Exploration LLC	406127	2011-04009	Lode
Cu 38	PM Exploration LLC	406128	2011-04010	Lode
Cu 39	PM Exploration LLC	406129	2011-04011	Lode
Cu 40	PM Exploration LLC	406130	2011-04012	Lode
Cu 41	PM Exploration LLC	406131	2011-04013	Lode
Cu 42	PM Exploration LLC	406132	2011-04014	Lode
Cu 43	PM Exploration LLC	406133	2011-04015	Lode
Cu 44	PM Exploration LLC	406134	2011-04016	Lode
Cu 45	PM Exploration LLC	406135	2011-04017	Lode
Cu 46	PM Exploration LLC	406136	2011-04018	Lode
Cu 47	PM Exploration LLC	406137	2011-04019	Lode
Cu 48	PM Exploration LLC	406138	2011-04020	Lode
Cu 49	PM Exploration LLC	406139	2011-04021	Lode
Cu 50	PM Exploration LLC	406140	2011-04022	Lode
Cu 51	PM Exploration LLC	406141	2011-04023	Lode
Cu 52	PM Exploration LLC	406142	2011-04024	Lode
Cu 53	PM Exploration LLC	406143	2011-04025	Lode
Cu 54	PM Exploration LLC	406144	2011-04026	Lode
Cu 55	PM Exploration LLC	406145	2011-04027	Lode
Cu 56	PM Exploration LLC	406146	2011-04028	Lode
Cu 57	PM Exploration LLC	406147	2011-04029	Lode
Cu 58	PM Exploration LLC	406148	2011-04030	Lode
Cu 59	PM Exploration LLC	406149	2011-04031	Lode
Cu 60	PM Exploration LLC	406150	2011-04032	Lode
Cu 61	PM Exploration LLC	406151	2011-04033	Lode
Cu 62	PM Exploration LLC	406152	2011-04034	Lode
Cu 63	PM Exploration LLC	406153	2011-04035	Lode
Cu 64	PM Exploration LLC	406154	2011-04036	Lode
Cu 65	PM Exploration LLC	406155	2011-04037	Lode
Cu 66	PM Exploration LLC	406156	2011-04038	Lode
Cu 67	PM Exploration LLC	406157	2011-04039	Lode
Cu 68	PM Exploration LLC	406158	2011-04040	Lode
Cu 69	PM Exploration LLC	406159	2011-04041	Lode
Cu 70	PM Exploration LLC	406160	2011-04042	Lode
Cu 71	PM Exploration LLC	✓406161	2011-04043	Lode

RECEIVED  
 BLM AZ STATE OFFICE  
 2011 AUG - 3 A 7:46  
 PHOENIX, ARIZONA

Cu 72	PM Exploration LLC	406162	2011-04044	Lode
Cu 73	PM Exploration LLC	406163	2011-04045	Lode
Cu 74	PM Exploration LLC	406164	2011-04046	Lode
Cu 75	PM Exploration LLC	406165	2011-04047	Lode
Cu 76	PM Exploration LLC	406166	2011-04048	Lode
Cu 77	PM Exploration LLC	406167	2011-04049	Lode
Cu 78	PM Exploration LLC	406168	2011-04050	Lode
Cu 79	PM Exploration LLC	406169	2011-04051	Lode
Cu 80	PM Exploration LLC	406170	2011-04052	Lode
Cu 81	PM Exploration LLC	406171	2011-04053	Lode
Cu 82	PM Exploration LLC	406172	2011-04054	Lode
Cu 83	PM Exploration LLC	406173	2011-04055	Lode
Cu 84	PM Exploration LLC	406174	2011-04056	Lode
Cu 85	PM Exploration LLC	406175	2011-04057	Lode
Cu 86	PM Exploration LLC	406176	2011-04058	Lode
Cu 87	PM Exploration LLC	406177	2011-04059	Lode
Cu 88	PM Exploration LLC	406178	2011-04060	Lode
Cu 89	PM Exploration LLC	406179	2011-04061	Lode
Cu 90	PM Exploration LLC	406180	2011-04062	Lode
Cu 91	PM Exploration LLC	406181	2011-04063	Lode
Cu 92	PM Exploration LLC	406182	2011-04064	Lode
Cu 93	PM Exploration LLC	406183	2011-04065	Lode
Cu 94	PM Exploration LLC	406184	2011-04066	Lode
Cu 95	PM Exploration LLC	406185	2011-04067	Lode
Cu 96	PM Exploration LLC	406186	2011-04068	Lode
Cu 97	PM Exploration LLC	406187	2011-04069	Lode
Cu 98	PM Exploration LLC	406188	2011-04070	Lode
Cu 99	PM Exploration LLC	406189	2011-04071	Lode
Cu 100	PM Exploration LLC	406190	2011-04072	Lode
Cu 101	PM Exploration LLC	406191	2011-04101	Lode
Cu 102	PM Exploration LLC	406192	2011-04102	Lode
Cu 103	PM Exploration LLC	406193	2011-04103	Lode
Cu 104	PM Exploration LLC	406194	2011-04104	Lode
Cu 105	PM Exploration LLC	406195	2011-04105	Lode
Cu 106	PM Exploration LLC	406196	2011-04106	Lode
Cu 107	PM Exploration LLC	406197	2011-04107	Lode
Cu 108	PM Exploration LLC	406198	2011-04108	Lode
Cu 109	PM Exploration LLC	406199	2011-04109	Lode
Cu 110	PM Exploration LLC	406200	2011-04110	Lode
Cu 111	PM Exploration LLC	406201	2011-04073	Lode
Cu 112	PM Exploration LLC	406202	2011-04074	Lode
Cu 113	PM Exploration LLC	406203	2011-04075	Lode
Cu 114	PM Exploration LLC	406204	2011-04076	Lode
Cu 115	PM Exploration LLC	406205	2011-04077	Lode
Cu 116	PM Exploration LLC	406206	2011-04078	Lode
Cu 117	PM Exploration LLC	406207	2011-04079	Lode
Cu 118	PM Exploration LLC	406208	2011-04080	Lode
Cu 119	PM Exploration LLC	✓406209	2011-04081	Lode

PIQUELIX, ARIZONA

2011 AUG -3 A 7:46

RECEIVED  
BLM AZ STATE OFFICE

Cu 120 PM Exploration LLC	406210	2011-04082	Lode
Cu 121 PM Exploration LLC	406211	2011-04083	Lode
Cu 122 PM Exploration LLC	406212	2011-04084	Lode
Cu 123 PM Exploration LLC	406213	2011-04085	Lode
Cu 124 PM Exploration LLC	406214	2011-04086	Lode
Cu 125 PM Exploration LLC	406215	2011-04087	Lode
Cu 126 PM Exploration LLC	406216	2011-04088	Lode
Cu 127 PM Exploration LLC	406217	2011-04089	Lode
Cu 128 PM Exploration LLC	406218	2011-04090	Lode
Cu 129 PM Exploration LLC	406219	2011-04091	Lode
Cu 130 PM Exploration LLC	406220	2011-04092	Lode
Cu 131 PM Exploration LLC	406221	2011-04093	Lode
Cu 132 PM Exploration LLC	406222	2011-04094	Lode
Cu 133 PM Exploration LLC	406223	2011-04095	Lode
Cu 134 PM Exploration LLC	406224	2011-04096	Lode
Cu 135 PM Exploration LLC	406225	2011-04097	Lode
Cu 136 PM Exploration LLC	406226	2011-04098	Lode
Cu 137 PM Exploration LLC	406227	2011-04099	Lode
Cu 138 PM Exploration LLC	406228	2011-04100	Lode
Cu 139 PM Exploration LLC	406229	2011-04111	Lode
Cu 140 PM Exploration LLC	406230	2011-04112	Lode
Cu 141 PM Exploration LLC	406231	2011-04113	Lode
Cu 142 PM Exploration LLC	406232	2011-04114	Lode
Cu 143 PM Exploration LLC	406233	2011-04115	Lode
Cu 144 PM Exploration LLC	406234	2011-04116	Lode
Cu 145 PM Exploration LLC	406235	2011-04117	Lode
Cu 146 PM Exploration LLC	406236	2011-04118	Lode
Cu 147 PM Exploration LLC	406237	2011-04119	Lode
Cu 148 PM Exploration LLC	406238	2011-04120	Lode
Cu 149 PM Exploration LLC	406239	2011-04121	Lode
Cu 150 PM Exploration LLC	406240	2011-04122	Lode
Cu 151 PM Exploration LLC	406241	2011-04123	Lode
Cu 152 PM Exploration LLC	406242	2011-04124	Lode
Cu 153 PM Exploration LLC	406243	2011-04125	Lode
Cu 154 PM Exploration LLC	406244	2011-04126	Lode
Cu 155 PM Exploration LLC	406245	2011-04127	Lode
Cu 156 PM Exploration LLC	406246	2011-04128	Lode
Cu 157 PM Exploration LLC	406247	2011-04129	Lode
Cu 158 PM Exploration LLC	406248	2011-04130	Lode
Cu 159 PM Exploration LLC	406249	2011-04131	Lode
Cu 160 PM Exploration LLC	406250	2011-04132	Lode
Cu 161 PM Exploration LLC	406251	2011-04133	Lode
Cu 162 PM Exploration LLC	406252	2011-04134	Lode
Cu 163 PM Exploration LLC	406253	2011-04135	Lode
Cu 164 PM Exploration LLC	406254	2011-04136	Lode
Cu 165 PM Exploration LLC	406255	2011-04137	Lode
Cu 166 PM Exploration LLC	406256	2011-04138	Lode
Cu 167 PM Exploration LLC	✓406257	2011-04139	Lode

PHOENIX, ARIZONA

2011 AUG - 3 A 7:46

RECEIVED  
BLM AZ STATE OFFICE



Cu 168 PM Exploration LLC	406258	2011-04140	Lode
Cu 169 PM Exploration LLC	406259	2011-04141	Lode
Cu 170 PM Exploration LLC	406260	2011-04142	Lode
Cu 171 PM Exploration LLC	406261	2011-04143	Lode
Cu 172 PM Exploration LLC	406262	2011-04144	Lode
Cu 173 PM Exploration LLC	406263	2011-04145	Lode
Cu 174 PM Exploration LLC	406264	2011-04146	Lode
Cu 175 PM Exploration LLC	406265	2011-04147	Lode
Cu 176 PM Exploration LLC	406266	2011-04148	Lode
Cu 177 PM Exploration LLC	406267	2011-04149	Lode
Cu 178 PM Exploration LLC	406268	2011-04150	Lode
Cu 179 PM Exploration LLC	406269	2011-04151	Lode
Cu 180 PM Exploration LLC	406270	2011-04152	Lode
Cu 181 PM Exploration LLC	406271	2011-04153	Lode
Cu 182 PM Exploration LLC	406272	2011-04154	Lode
Cu 183 PM Exploration LLC	406273	2011-04155	Lode
Cu 184 PM Exploration LLC	406274	2011-04156	Lode
Cu 185 PM Exploration LLC	406275	2011-04157	Lode
Cu 186 PM Exploration LLC	406276	2011-04158	Lode
Cu 187 PM Exploration LLC	406277	2011-04159	Lode
Cu 188 PM Exploration LLC	406278	2011-04160	Lode
Cu 189 PM Exploration LLC	406279	2011-04161	Lode
Cu 190 PM Exploration LLC	406280	2011-04162	Lode
Cu 191 PM Exploration LLC	406281	2011-04163	Lode
Cu 192 PM Exploration LLC	406282	2011-04164	Lode
Cu 193 PM Exploration LLC	406283	2011-04165	Lode
Cu 194 PM Exploration LLC	406284	2011-04166	Lode
Cu 195 PM Exploration LLC	406285	2011-04167	Lode
Cu 196 PM Exploration LLC	406286	2011-04168	Lode
Cu 197 PM Exploration LLC	406287	2011-04169	Lode
Cu 198 PM Exploration LLC	406288	2011-04170	Lode
Cu 199 PM Exploration LLC	406289	2011-04171	Lode
Cu 200 PM Exploration LLC	406290	2011-04172	Lode
Cu 201 PM Exploration LLC	406291	2011-04173	Lode
Cu 202 PM Exploration LLC	406292	2011-04174	Lode
Cu 203 PM Exploration LLC	406293	2011-04175	Lode
Cu 204 PM Exploration LLC	406294	2011-04176	Lode
Cu 205 PM Exploration LLC	406295	2011-04177	Lode
Cu 206 PM Exploration LLC	406296	2011-04178	Lode
Cu 207 PM Exploration LLC	406297	2011-04179	Lode
Cu 208 PM Exploration LLC	406298	2011-04180	Lode
Cu 209 PM Exploration LLC	406299	2011-04181	Lode
Cu 210 PM Exploration LLC	406300	2011-04182	Lode
Cu 211 PM Exploration LLC	406301	2011-04183	Lode
Cu 212 PM Exploration LLC	✓ 406302	2011-04184	Lode

PHOENIX, ARIZONA

2011 AUG - 3 A 7 46

RECEIVED  
BLM AZ STATE OFFICE

**United States Department of the Interior**  
**Bureau of Land Management**  
 LANDS/RECREATION & PLANNING  
 ONE N CENTRAL AVE  
 PHOENIX, AZ 85004 -2203  
 Phone: 602-417-9200

Receipt

No:

2396009

<b>Transaction #:</b> 2471127	
<b>Date of Transaction:</b> 08/03/2011	
<b>CUSTOMER:</b>	
DECONCINI MCDONALD YETWIN & LACY 2525 E BROADWAY BLVD STE 200 TUCSON, AZ 85716-5300 US	

LINE #	QTY	DESCRIPTION	REMARKS	UNIT PRICE	TOTAL
1	1.00	LOCATABLE MINERALS / MINING CLAIMS-NOT NEW-UNADJUD, ONE AUTH NO. ONLY / MINING CLAIM MONEY RECEIVED <b>CASES: AMC366532/\$38360.00</b>	MAINT-274	- n/a -	38360.00
<b>TOTAL:</b>					<b>\$38,360.00</b>

PAYMENT INFORMATION					
1	AMOUNT:	38360.00	POSTMARKED:	N/A	
	TYPE:	CHECK	RECEIVED:	08/03/2011	
	CHECK NO:	604032228			
	NAME:	STRATON RESOURCES INC 700-1199 W HASTING ST VANCOUVER, CANADA BRITISH COLUMBIA NS V6E 3T5			

REMARKS

This receipt was generated by the automated BLM Collections and Billing System and is a paper representation of a portion of the official electronic record contained therein.

AMC 361955  
 AMC 361755  
 AMC 366532  
 AMC 383267

Notice Of Intention To Hold Mining Claim(s)

This Notice of Intention to Hold Mining Claim(s) is made pursuant to 43 C.F.R., subpart 3833.2.3, by:

Name (owner or agent) P.M. EXPLORATION LLC

Address 2207 CRESCENT DRIVE

City, State, Zip DODGE CITY, KS. 67801

Claim Name	BLM AMC#	Cochise County Recording #
<u>KPD#001</u>	<u>AMC366532</u>	<u>050725415</u>
<u>KPD#004</u>	<u>AMC366533</u>	<u>050725416</u>
<u>KPD#005</u>	<u>AMC366534</u>	<u>050725417</u>
<u>KPD#006</u>	<u>AMC366535</u>	<u>050725418</u>
<u>KPD#008</u>	<u>AMC366536</u>	<u>050725419</u>
<u>KPD#009</u>	<u>AMC366537</u>	<u>050725419</u>
<u>KPD#010</u>	<u>AMC383267</u>	<u>070517894</u>
<u>KPD#011</u>	<u>AMC383268</u>	<u>070517895</u>

RECEIVED  
 BLM AZ STATE OFFICE  
 2010 AUG 16 P 12:34  
 PHOENIX, ARIZONA

ADDITIONAL CLAIMS ARE LISTED ON ATTACHED SHEET

The above named claim(s) is (are) held claimed by the owner(s) for the valuable mineral contained therein. I (we) intend to continue development of the claim(s).

Annual assessment work or report of geological, geochemical or geophysical survey is not required because the owner has paid a rental fee of \$140.00 per claim for the assessment year ending August 31, 2010 and is paying \$140.00 per claim for an advanced rental fee for the assessment work for the year beginning on September 1, 2010. Owner further states that mineral production activities have occurred upon the claims during the last assessment year that would normally qualify as annual assessment work.

Signed [Signature]

Date 7-10-10

NO. OF CLAIMS 34  
 AMOUNT \$4760.00  
 RECEIPT NO. 2191733  
 INIT. A.P.  
 \*\* BLM-ASO \*\*

ADDITIONAL CLAIMS FOR P.M. EXPLORATION LLC

Notice of Intention To Hold Mining Claims

Claim Name	BLM AMC#	Cochise Co. Recording #
KPD#012	AMC366538	050725420
KPD#015	AMC366539	050725421
KPD#016	AMC366540	050725422
KPD#017	AMC366541	050725423
KPD#018	AMC366542	050725424
KPD#019	AMC366543	050725425
KPD#020	AMC366544	050725426
KPD#021	AMC366545	050725427
KPD#022	AMC366546	050725428
KPD#023	AMC366547	050725429
KPD#024	AMC366548	050725430
KPD#025	AMC366549	050725431
KPD#026	AMC366550	050725432
KPD#027	AMC366551	050725433
KPD#029	AMC383269	070517896
KPD#030	AMC383270	070517897
KPD#034	AMC366552	050725434
KPD#035	AMC366553	050725435
KPD#043	AMC366554	050725436
KPD#048	AMC366555	050725437
KPD#057	AMC366556	050725438
KPD#060	AMC366557	050725439
N.D.#10	AMC361755	040617412
N.D.#11	AMC361756	040617413
N.D.#12	AMC361955	040620541
N.D.#13	AMC361956	040620540

RECEIVED  
BLM AZ STATE OFFICE  
2010 AUG 16 P. 12: 34  
PHOENIX, ARIZONA

Signed

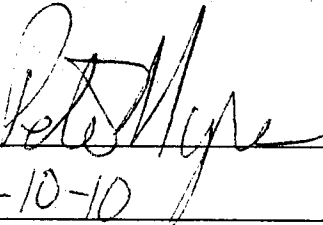

Date

7-10-10

ENTERED INTO COMPUTER

AUG 23 2010

**United States Department of the Interior**  
**Bureau of Land Management**  
 LANDS/RECREATION & PLANNING  
 ONE N CENTRAL AVE  
 PHOENIX, AZ 85004 -2203  
 Phone:

Receipt

No: 2191733

<b>Transaction #:</b> 2261490		<b>ENTERED INTO COMPUTER</b>
<b>Date of Transaction:</b> 08/16/2010		
<b>CUSTOMER:</b>	P.M. EXPLORATION LLC 2207 CRESCENT DR DODGE CITY,KS 67801-2827 US	AUG 23 2010

LINE #	QTY	DESCRIPTION	REMARKS	UNIT PRICE	TOTAL
1	1.00	LOCATABLE MINERALS / MINING CLAIMS-NOT NEW-UNADJUD,ONE AUTH NO. ONLY / MINING CLAIM MONEY RECEIVED CASES: AMC366532/\$4760.00	MAINT FEE PYMNT (34) 2011	- n/a -	4760.00
<b>TOTAL:</b>					<b>\$4,760.00</b>

PAYMENT INFORMATION			
1	<b>AMOUNT:</b>	4760.00	<b>POSTMARKED:</b> N/A
	<b>TYPE:</b>	FOREIGN CHECK	<b>RECEIVED:</b> 08/16/2010
	<b>CHECK NO:</b>	645146	
	<b>NAME:</b>	AZ COPPER CORP 675 HASTINGS ST W VANCOUVER BC V6B1N2 CA	

REMARKS

This receipt was generated by the automated BLM Collections and Billing System and is a paper representation of a portion of the official electronic record contained therein.

AMC 388635  
366532  
383267  
361755  
361955

Notice Of Intention To Hold Mining Claim(s)

This Notice of Intention to Hold Mining Claim(s) is made pursuant to 43 C.F.R., subpart 3833.2.3, by:

Name (owner or agent) D. D. Exploration LLC

Address 2207 CRESCENT DRIVE

City, State, Zip DODGE CITY, KS. 67801

Claim Name	BLM AMC#	Cochise County Recording #
Toni Ann #001	AMC 388635	071136135
Toni Ann #002	AMC 388636	071136134

The above named claim(s) is (are) held claimed by the owner(s) for the valuable mineral contained therein. I (we) intend to continue development of the claim(s).

Annual assessment work or report of geological, geochemical or geophysical survey is not required because the owner is paying \$125.00 per claim for an advanced rental fee for the assessment work for the year beginning on September 1, 2008. Owner further states that mineral production activities have occurred upon the claims during the last assessment year that would normally qualify as annual assessment work.

Signed Peter Meyer

Date 8-21-08

ENTERED INTO COMPUTER  
9/14/08 QB

Notice Of Intention To Hold Mining Claim(s)

This Notice of Intention to Hold Mining Claim(s) is made pursuant to 43 C.F.R., subpart 3833.2.3, by:

Name (owner or agent) P.M. EXPLORATION LLC

Address 2207 CRESCENT DRIVE

City, State, Zip DODGE CITY, KS. 67801

Claim Name	BLM AMC#	Cochise County Recording #
L KPD#001	AMC366532	050725415
KPD#004	AMC366533	050725416
KPD#005	AMC366534	050725417
KPD#006	AMC366535	050725418
KPD#008	AMC366536	050725419
KPD#009	AMC366537	050725419
L KPD#010	AMC383267	070517894
KPD#011	AMC383268	070517895

ADDITIONAL CLAIMS ARE LISTED ON ATTACHED SHEET

The above named claim(s) is (are) held claimed by the owner(s) for the valuable mineral contained therein. I (we) intend to continue development of the claim(s).

Annual assessment work or report of geological, geochemical or geophysical survey is not required because the owner has paid a rental fee of \$125.00 per claim for the assessment year ending September 1, 2008 and is paying \$125.00 per claim for an advanced rental fee for the assessment work for the year beginning on September 1, 2009. Owner further states that mineral production activities have occurred upon the claims during the last assessment year that would normally qualify as annual assessment work.

Signed Peter Myer

Date 8-21-08

ADDITIONAL CLAIMS FOR P.M. EXPLORATION LLC

Notice of Intention To Hold Mining Claims

Claim Name	BLM AMC#	Cochise Co. Recording #
KPD#012	AMC366538	050725420
KPD#015	AMC366539	050725421
KPD#016	AMC366540	050725422
KPD#017	AMC366541	050725423
KPD#018	AMC366542	050725424
KPD#019	AMC366543	050725425
KPD#020	AMC366544	050725426
KPD#021	AMC366545	050725427
KPD#022	AMC366546	050725428
KPD#023	AMC366547	050725429
KPD#024	AMC366548	050725430
KPD#025	AMC366549	050725431
KPD#026	AMC366550	050725432
KPD#027	AMC366551	050725433
KPD#029	AMC383269	070517896
KPD#030	AMC383270	070517897
KPD#034	AMC366552	050725434
KPD#035	AMC366553	050725435
KPD#043	AMC366554	050725436
KPD#048	AMC366555	050725437
KPD#057	AMC366556	050725438
KPD#060	AMC366557	050725439
N.D.#10	AMC361755	040617412
N.D.#11	AMC361756	040617413
N.D.#12	AMC361955	040620541
N.D.#13	AMC361956	040620540

Signed

*Peter Myers*

Date

8-21-08



**United States Department of the Interior**  
**Bureau of Land Management**  
 BUSINESS & SUPPORT SVCS DIV  
 ONE N CENTRAL AVE SUITE 800  
 PHOENIX, AZ 85004 -4427  
 Phone: (602) 417-9200

Receipt

No:

1771434

<b>Transaction #:</b> 1829140	
<b>Date of Transaction:</b> 08/26/2008	
<b>CUSTOMER:</b>	D.D. EXPLORATION, L.L.C 2207 CRESCENT DR DODGE CITY,KS 67801

LINE #	QTY	DESCRIPTION	REMARKS	UNIT PRICE	TOTAL
1	1.00	LOCATABLE MINERALS / MINING CLAIMS-NOT NEW-UNADJUD,ONE AUTH NO. ONLY / MINING CLAIM MONEY RECEIVED (455) CASES: AMC366538/\$4500.00	MAINT 2009	- n/a -	4500.00
<b>TOTAL:</b>					<b>\$4,500.00</b>

PAYMENT INFORMATION					
1	AMOUNT:	\$4,250.00	POSTMARKED:	8/21/08 0:00	
	TYPE:	CHECK	RECEIVED:	08/26/2008	
	CHECK NO:	1482			
	NAME:	MYERS, PETER D 2207 CRESCENT DR DODGE CITY KS 67801			
2	AMOUNT:	\$250.00	POSTMARKED:	8/21/08 0:00	
	TYPE:	CHECK	RECEIVED:	08/26/2008	
	CHECK NO:	1483			
	NAME:	MYERS, PETER D 2207 CRESCENT DR DODGE CITY KS 67801			

REMARKS

This receipt was generated by the automated BLM Collections and Billing System and is a paper representation of a portion of the official electronic record contained therein.

AMC 366532  
383267  
361755  
361955

Notice Of Intention To Hold Mining Claim(s)

This Notice of Intention to Hold Mining Claim(s) is made pursuant to 43 C.F.R., subpart 3833.2.3, by:

Name (owner or agent) P.M. EXPLORATION LLC

Address 2207 CRESCENT DRIVE

City, State, Zip DODGE CITY, KS. 67801

Claim Name	BLM AMC#	Cochise County Recording #
<u>KPD#001</u>	<u>AMC366532</u>	<u>050725415</u>
<u>KPD#004</u>	<u>AMC366533</u>	<u>050725416</u>
<u>KPD#005</u>	<u>AMC366534</u>	<u>050725417</u>
<u>KPD#006</u>	<u>AMC366535</u>	<u>050725418</u>
<u>KPD#008</u>	<u>AMC366536</u>	<u>050725419</u>
<u>KPD#009</u>	<u>AMC366537</u>	<u>050725419</u>
<u>KPD#010</u>	<u>AMC383267</u>	<u>070517894</u>
<u>KPD#011</u>	<u>AMC383268</u>	<u>070517895</u>

PHOENIX, ARIZONA

2007 AUG 30 P 4: 27

RECEIVED  
B.L.M. AZ STATE OFFICE

8004

ADDITIONAL CLAIMS ARE LISTED ON ATTACHED SHEET

The above named claim(s) is (are) held claimed by the owner(s) for the valuable mineral contained therein. I (we) intend to continue development of the claim(s).

Annual assessment work or report of geological, geochemical or geophysical survey is not required because the owner has paid a rental fee of \$125.00 per claim for the assessment year ending September 1, 2006 and is paying \$125.00 per claim for an advanced rental fee for the assessment work for the year beginning on September 1, 2007. Owner further states that mineral production activities have occurred upon the claims during the last assessment year that would normally qualify as annual assessment work.

Signed Peter Myers

Date 8-24-07

ENTERED INTO COMPUTER  
9/10/2007 PB + VERIFIED

ADDITIONAL CLAIMS FOR P.M. EXPLORATION LLC

Notice of Intention To Hold Mining Claims

Claim Name	BLM AMC#	Cochise Co. Recording #
KPD#012	AMC366538	050725420
KPD#015	AMC366539	050725421
KPD#016	AMC366540	050725422
KPD#017	AMC366541	050725423
KPD#018	AMC366542	050725424
KPD#019	AMC366543	050725425
KPD#020	AMC366544	050725426
KPD#021	AMC366545	050725427
KPD#022	AMC366546	050725428
KPD#023	AMC366547	050725429
KPD#024	AMC366548	050725430
KPD#025	AMC366549	050725431
KPD#026	AMC366550	050725432
KPD#027	AMC366551	050725433
KPD#029	AMC383269	070517896
KPD#030	AMC383270	070517897
KPD#034	AMC366552	050725434
KPD#035	AMC366553	050725435
KPD#043	AMC366554	050725436
KPD#048	AMC366555	050725437
KPD#057	AMC366556	050725438
KPD#060	AMC366557	050725439

22  
EAG

Signed Peter Myers  
Date 8-24-07

RECEIVED  
B.L.M. AZ STATE OFFICE  
2007 AUG 30 P 4: 27  
PHOENIX, ARIZONA

**NOTICE OF INTENTION TO HOLD MINING CLAIMS(S)**

This Notice of Intention to Hold Mining Claim(s) is made pursuant to 43 C.F.R., subpart 3833.2.3, by:

Name (owner or agent) D.D. EXPLORATION LLC  
 Address 2207 CRESCENT DR.  
 City, State, Zip DODGE CITY, KS 67801

<u>Claim Name</u>	<u>BLM AMC#</u>	<u>COCHISE COUNTY RECORDING#</u>
<u>N.D.#10</u>	<u>AMC361755</u>	<u>040617412</u>
<u>N.D.#11</u>	<u>AMC361756</u>	<u>040617413</u>
<u>N.D.#12</u>	<u>AMC361955</u>	<u>040620541</u>
<u>N.D.#13</u>	<u>AMC361956</u>	<u>040620540</u>

RECEIVED  
 BLM ARIZONA STATE OFFICE  
 PHOENIX, ARIZONA  
 2007 AUG 30 P 4: 25

(4)  
 EAC

The above named claim(s) is (are) held and claimed by the owner(s) for the valuable mineral contained therein. I (we) intend to continue development of the claim(s).

Annual assessment work or report of geological, geochemical or geophysical survey is not required because OWNER IS PAYING AN ADVANCED RENTAL FEE OF \$125.00 PER CLAIM FOR THE ASSESSMENT YEAR BEGINNING SEPTEMBER 1, 2007. OWNER STATES FOR MINERAL PRODUCTION ACTIVITIES HAVE OCCURRED ON THE CLAIMS THAT WOULD NORMALLY QUALIFIED FOR ANNUAL ASSESSMENT WORK FOR THE YEAR ENDING SEPTEMBER 1, 2007

Signed By Peter Meyer  
 Date 8-24-07

**United States Department of the Interior**  
**Bureau of Land Management**  
 BUSINESS & SUPPORT SVCS DIV  
 ONE N CENTRAL AVE SUITE 800  
 PHOENIX, AZ 85004 -4427  
 Phone: (602) 417-9200

Receipt

No: 1558280

Transaction #: 1609924		<b>ENTERED INTO COMPUTER</b>
Date of Transaction: 08/30/2007		
CUSTOMER:	PETER MYERS 2207 CRESCENT DR DODGE CITY,KS 67801	SEP 10 2007 <b>PB</b> + <b>VERIFIED</b>

LINE #	QTY	DESCRIPTION	REMARKS	UNIT PRICE	TOTAL
1	1.00	LOCATABLE MINERALS / MINING CLAIMS- NOT NEW-UNADJUD, ONE AUTH NO. ONLY / MINING CLAIM MONEY RECEIVED (455) CASES: AMC366532/\$4250.00	MAINT 2008 (34)	- n/a -	4250.00
<b>TOTAL:</b>					<b>\$4,250.00</b>

PAYMENT INFORMATION			
NOTE: Items will appear on credit card statement as "Bureau of Land Management".			
1	AMOUNT:	\$4,250.00	POSTMARKED: N/A
	TYPE:	CREDIT CARD	RECEIVED: 08/30/2007
	NAME:	MYERS, PETER 2207 CRESCENT DR DODGE CITY KS 67801	
	CARD NO:	XXXXXXXXXXXX9231	AUTH CODE: 03551B
	NAME ON CARD:	PETER D MYERS	
	EXPIRES:	06/30/2009	
	SIGNATURE:		

REMARKS

This receipt was generated by the automated BLM Collections and Billing System and is a paper representation of a portion of the official electronic record contained therein.

361755-361756  
 366532-366557 361955-361956  
 383267-383270

Dear B. L. M., 8-24-07  
Please record these  
"Notice of Intention to Hold  
Mining Claims." There is  
a total of 34 claims,  
at \$125 each, which  
makes the total fees \$4,250.<sup>00</sup>  
I would like to pay the  
fees with my MasterCard.

the # is [REDACTED]  
[REDACTED], the expiration date is 06/09.  
The name on the card is  
Peter D. Myers.

Please call me if you  
have any questions or  
problems.  
Thanks for your time.

Yours Truly,  
Pete Myers  
620 430 3188  
620 225 1991

# Message:

34 ROWS RETRIEVED

## CBS Export Results Report

Include Resolved Records

### Record Status

### Search Criteria Responsible Ar

Error Records (E/M/I)

Enter export Date (mm/dd/yyyy) ALL

User (U,X)

Accepted Records (A/W)

Serial Number match (optional)

Programme

"On Hold" Records (H)

Receipt Nr (optional) 1558280

All (U,P,X)

All Records (for s/n or receipt nr)

Export Nr (exclusive)

Exported, No Results From CBS

LR2000 User (defaults to login) ALL

New (not yet exported)

Query

Reset

User

	Resend?	Export Nr	A/D	Serial Nr	Mult	Code	\$ Amount	Remarks	Receipt Nr	LR2000 User	#Msg
1	<input type="checkbox"/>	1489930	A	AMC361755		582	125.00	2008	1558280	P5BROWN	1

366532

383267

361755

361955

ADDITIONAL CLAIMS FOR P.M. EXPLORATION LLC  
NOTICE OF INTENTION TO HOLD MINING CLAIMS

AMC 366557  
AMC 361755  
AMC 361955

<u>CLAIM NAME</u>	<u>BLM AMC#</u>	<u>COCHISE COUNTY RECORDING #</u>
KPD#016	AMC366540	050725422
KPD#017	AMC366541	050725423
KPD#018	AMC366542	050725424
KPD#019	AMC366543	050725425
KPD#020	AMC366544	050725426
KPD#021	AMC366545	050725427
KPD#022	AMC366546	050725428
KPD#023	AMC366547	050725429
KPD#024	AMC366548	050725430
KPD#025	AMC366549	050725431
KPD#026	AMC366550	050725432
KPD#027	AMC366551	050725433
KPD#034	AMC366552	050725434
KPD#035	AMC366553	050725435
KPD#043	AMC366554	050725436
KPD#048	AMC366555	050725437
KPD#057	AMC366556	050725438
KPD#060	AMC366557	050725439

SIGNED BY

DATE

Peter Meyer  
8-28-06

PHOENIX, AZ

2006 AUG 31 P 3:17

RECEIVED  
BLM/AZ STATE OFFICE

RE 9/14/06



**NOTICE OF INTENTION TO HOLD MINING CLAIMS(S)**

This Notice of Intention to Hold Mining Claim(s) is made pursuant to 43 C.F.R., subpart 3833.2.3, by:

Name (owner or agent) P.M. EXPLORATION LLC

Address 2207 CRESCENT DR.

City, State, Zip DODGE CITY, KS 67801

<u>Claim Name</u>	<u>BLM AMC#</u>	<u>COCHISE COUNTY RECORDING #</u>
<u>KPD#001</u>	<u>AMC366532</u>	<u>050725415</u>
<u>KPD#004</u>	<u>AMC366533</u>	<u>050725416</u>
<u>KPD#005</u>	<u>AMC366534</u>	<u>050725417</u>
<u>KPD#006</u>	<u>AMC366535</u>	<u>050725418</u>
<u>KPD#008</u>	<u>AMC366536</u>	<u>050725419</u>
<u>KPD#009</u>	<u>AMC366537</u>	<u>050725419</u>
<u>KPD#012</u>	<u>AMC366538</u>	<u>050725420</u>
<u>KPD#015</u>	<u>AMC366539</u>	<u>050725421</u>

ADDITIONAL CLAIMS ARE LISTED ON ATTACHED SHEET

The above named claim(s) is (are) held and claimed by the owner(s) for the valuable mineral contained therein. I (we) intend to continue development of the claim(s).

Annual assessment work or report of geological, geochemical or geophysical survey is not required because

OWNER HAS PAID A RENTAL FEE OF \$125.00 PER CLAIM FOR THE ASSESSMENT YEAR ENDING SEPTEMBER 1, 2006 AND IS PAYING \$125.00 PER CLAIM FOR AN ADVANCED RENTAL FEE FOR THE ASSESSMENT WORK FOR THE YEAR BEGINNING ON SEPTEMBER 1, 2006. OWNER FURTHER STATES THAT MINERAL PRODUCTION ACTIVITIES HAVE OCCURRED UPON THE CLAIMS DURING THE LAST ASSESSMENT YEAR THAT WOULD NORMALLY QUALIFIED AS ANNUAL ASSESSMENT WORK.

Signed by Pete Meyer

Date 8-28-06

RECEIVED  
 CLIMATE SERVICES OFFICE  
 PHOENIX, AZ  
 2006 AUG 31 P 3 11

NOTICE OF INTENTION TO HOLD MINING CLAIMS(S)

This Notice of Intention to Hold Mining Claim(s) is made pursuant to 43 C.F.R., subpart 3833.2.3, by:

Name (owner or agent) D.D. EXPLORATION LLC  
 Address 2207 CRESCENT DR.  
 City, State, Zip DODGE CITY, KS 67801

<u>Claim Name</u>	<u>BLM AMC#</u>	<u>COCHISE COUNTY RECORDING#</u>
<u>N.D.#10</u>	<u>AMC361755</u>	<u>040617412</u>
<u>N.D.#11</u>	<u>AMC361756</u>	<u>040617413</u>
<u>N.D.#12</u>	<u>AMC361955</u>	<u>040620541</u>
<u>N.D.#13</u>	<u>AMC361956</u>	<u>040620540</u>
<u> </u>	<u> </u>	<u> </u>
<u> </u>	<u> </u>	<u> </u>
<u> </u>	<u> </u>	<u> </u>
<u> </u>	<u> </u>	<u> </u>
<u> </u>	<u> </u>	<u> </u>
<u> </u>	<u> </u>	<u> </u>

RECEIVED  
 PHOENIX, AZ  
 2006 AUG 31 10 31 AM  
 LIAISON STATE OFFICE

The above named claim(s) is (are) held and claimed by the owner(s) for the valuable mineral contained therein. I (we) intend to continue development of the claim(s).

Annual assessment work or report of geological, geochemical or geophysical survey is not required because OWNER IS PAYING AN ADVANCED RENTAL FEE OF \$125.00 PER CLAIM FOR THE ASSESSMENT YEAR BEGINNING SEPTEMBER 1, 2006. OWNER STATES FOR MINERAL PRODUCTION ACTIVITIES HAVE OCCURRED ON THE CLAIMS THAT WOULD NORMALLY QUALIFIED FOR ANNUAL ASSESSMENT WORK FOR THE YEAR ENDING SEPTEMBER 1, 2006.

Signed by Pete Meyer  
 Date 8-28-06

United States Department of the Interior  
 Bureau of Land Management  
 BUSINESS & SUPPORT SVCS DIV  
 ONE N CENTRAL AVE  
 PHOENIX, AZ 85004 -2203  
 Phone: (602) 417-9200

Receipt

No:

1352125

<b>Transaction #:</b> 1397475	
<b>Date of Transaction:</b> 09/06/2006	
<b>CUSTOMER:</b>	PETER MYERS 2207 CRESCENT DODGE CITY,KS 67801

LINE #	QTY	DESCRIPTION	REMARKS	UNIT PRICE	TOTAL
1	1.00	LOCATABLE MINERALS / MINING CLAIMS-NOT NEW-UNADJUD,ONE AUTH NO. ONLY / MINING CLAIM MONEY RECEIVED (455) CASES: AMC361755/\$3750.00	MAINT 2007 (30)	- n/a -	3750.00
<b>TOTAL:</b>					<b>\$3,750.00</b>

PAYMENT INFORMATION					
1	AMOUNT:	\$3,750.00	POSTMARKED:	08/29/2006	
	TYPE:	CHECK	RECEIVED:	09/01/2006	
	CHECK NO:	9118			
	NAME:	MYERS, PETER D 2207 CRESCENT DODGE CITY KS 67801			

REMARKS

This receipt was generated by the automated BLM Collections and Billing System and is a paper representation of a portion of the official electronic record contained therein.

AMC 361755 & AMC 361756 T. 23 S., R. 20 E., Sec. 30 & 31, G&SRM, Cochise  
County, AZ

This notice is to inform you that BLM land records show that portions of the subject mining claim(s) lie within lands that have been patented.

The United States has no mineral or surface rights on these patented lands.

A copy of the Master Title Plat is enclosed for reference.

8-29-05  
LEAD CASE FILES  
AMC 361755 (755)  
AMC 361795  
AMC 366532

BLM,

Please record these "Notice of Intention to Hold Mining Claims"

There are 26 ~~to~~ K.P.D.# Claims for P.M. Exploration & 4 N.D.# Claims for D.D. Exploration.

At \$125 each it comes to a total of \$3,750.00

Please bill my credit card.

MasterCard #

expires ~~06/2006~~ 06/06

Peter D. Myers  
2207 Crescent Dr  
Dodge City, KS 67801



Please call if you have any questions or problems. 620 430 3188 or 620 225 1991

yours truly,



RECEIVED  
BUREAU OF  
LAND MANAGEMENT  
2005 AUG 31 P 12:29  
ARIZONA  
STATE OFFICE  
PHOENIX, ARIZON

ENTERED IN COMPUTER  
RE 9/19/05

**NOTICE OF INTENTION TO HOLD MINING CLAIMS(S)**

This Notice of Intention to Hold Mining Claim(s) is made pursuant to 43 C.F.R., subpart 3833.2.3, by:

Name (owner or agent) D.D. EXPLORATION LLC

Address 2207 CRESCENT DR.

City, State, Zip DODGE CITY, KS 67801

<u>Claim Name</u>	<u>BLM AMC#</u>	<u>COCHISE COUNTY RECORDING#</u>
<u>N.D.#10</u>	<u>AMC361755</u>	<u>040617412</u>
<u>N.D.#11</u>	<u>AMC361756</u>	<u>040617413</u>
<u>N.D.#12</u>	<u>AMC361955</u>	<u>040620541</u>
<u>N.D.#13</u>	<u>AMC361956</u>	<u>040620540</u>

(4)

RECEIVED  
 BUREAU OF  
 LAND MANAGEMENT  
 2005 AUG 31 P 12: 29  
 ARIZONA  
 STATE OFFICE  
 TUCSON, ARIZONA

The above named claim(s) is (are) held and claimed by the owner(s) for the valuable mineral contained therein. I (we) intend to continue development of the claim(s).

Annual assessment work or report of geological, geochemical or geophysical survey is not required because OWNER IS PAYING AN ADVANCED RENTAL FEE OF \$125.00 PER CLAIM FOR THE ASSESSMENT YEAR BEGINNING SEPTEMBER 1, 2005. OWNER STATES FOR MINERAL PRODUCTION ACTIVITIES HAVE OCCURRED ON THE CLAIMS THAT WOULD NORMALLY QUALIFIED FOR ANNUAL ASSESSMENT WORK FOR THE YEAR ENDING SEPTEMBER 1, 2005.

Signed By 

Date 8-29-05

RE 9/19/05

**NOTICE OF INTENTION TO HOLD MINING CLAIMS(S)**

This Notice of Intention to Hold Mining Claim(s) is made pursuant to 43 C.F.R., subpart 3833.2.3, by:

Name (owner or agent) P.M. EXPLORATION LLC  
 Address 2207 CRESCENT DR.  
 City, State, Zip DODGE CITY, KS 67801

<u>Claim Name</u>	<u>BLM AMC#</u>	<u>COCHISE COUNTY RECORDING #</u>
<u>KPD#001</u>	<u>AMC366532</u>	<u>050725415</u>
<u>KPD#004</u>	<u>AMC366533</u>	<u>050725416</u>
<u>KPD#005</u>	<u>AMC366534</u>	<u>050725417</u>
<u>KPD#006</u>	<u>AMC366535</u>	<u>050725418</u>
<u>KPD#008</u>	<u>AMC366536</u>	<u>050725419</u>
<u>KPD#009</u>	<u>AMC366537</u>	<u>050725419</u>
<u>KPD#012</u>	<u>AMC366538</u>	<u>050725420</u>
<u>KPD#015</u>	<u>AMC366539</u>	<u>050725421</u>

RECEIVED  
 BUREAU OF  
 LAND MANAGEMENT  
 ARIZONA  
 STATE OFFICE  
 TUCSON  
 2005 AUG 31 P 12:30

(8)

ADDITIONAL CLAIMS ARE LISTED ON ATTACHED SHEET

The above named claim(s) is (are) held and claimed by the owner(s) for the valuable mineral contained therein. I (we) intend to continue development of the claim(s).

Annual assessment work or report of geological, geochemical or geophysical survey is not required because

OWNER HAS PAID A RENTAL FEE OF \$125.00 PER CLAIM FOR THE ASSESSMENT YEAR ENDING SEPTEMBER 1, 2005 AND IS PAYING \$125.00 PER CLAIM FOR AN ADVANCED RENTAL FEE FOR THE ASSESSMENT WORK FOR THE YEAR BEGINNING ON SEPTEMBER 1, 2005. OWNER FURTHER STATES THAT MINERAL PRODUCTION ACTIVITIES HAVE OCCURRED UPON THE CLAIMS DURING THE LAST ASSESSMENT YEAR THAT WOULD NORMALLY QUALIFIED AS ANNUAL ASSESSMENT WORK.

Signed by *[Signature]*  
 Date 8-29-05

RE 9/19/05

ADDITIONAL CLAIMS FOR P.M. EXPLORATION LLC  
NOTICE OF INTENTION TO HOLD MINING CLAIMS

<u>CLAIM NAME</u>	<u>BLM AMC#</u>	<u>COCHISE COUNTY RECORDING #</u>
KPD#016	AMC366540	050725422
KPD#017	AMC366541	050725423
KPD#018	AMC366542	050725424
KPD#019	AMC366543	050725425
KPD#020	AMC366544	050725426
KPD#021	AMC366545	050725427
KPD#022	AMC366546	050725428
KPD#023	AMC366547	050725429
KPD#024	AMC366548	050725430
KPD#025	AMC366549	050725431
KPD#026	AMC366550	050725432
KPD#027	AMC366551	050725433
KPD#034	AMC366552	050725434
KPD#035	AMC366553	050725435
KPD#043	AMC366554	050725436
KPD#048	AMC366555	050725437
KPD#057	AMC366556	050725438
KPD#060	AMC366557	050725439

18

SIGNED BY

Peter Myr

DATE

8-29-05

ARIZONA  
STATE OFFICE  
PHOENIX, ARIZONA

2005 AUG 31 P 12:30

RECEIVED  
BUREAU OF  
LAND MANAGEMENT

RE 9/19/05



**United States Department of the Interior  
Bureau of Land Management  
BUSINESS & SUPPORT SVCS DIV  
222 N CENTRAL AVE  
PHOENIX, AZ 85004 -2203  
Phone: (602) 417-9200**

Receipt

No: 1143092

<b>Transaction #:</b> 1182371	
<b>Date of Transaction:</b> 09/01/2005	
<b>CUSTOMER:</b>	PETER MYERS 2207 CRESCENT DODGE CITY,KS 67801

LINE #	QTY	DESCRIPTION	REMARKS	UNIT PRICE	TOTAL
1	1.00	LOCATABLE MINERALS / MINING CLAIMS- NOT NEW-UNADJUD,ONE AUTH NO. ONLY / MINING CLAIM MONEY RECEIVED (455) CASES: AMC361755/\$3750.00	MAINT 2006 (30)	- n/a -	3750.00
<b>TOTAL:</b>					<b>\$3,750.00</b>

PAYMENT INFORMATION			
NOTE: Items will appear on credit card statement as "Bureau of Land Management".			
1	AMOUNT:	\$3,750.00	POSTMARKED: N/A
	TYPE:	CREDIT CARD	RECEIVED: 09/01/2005
	NAME:	MYERS, PETER 2207 CRESCENT DODGE CITY KS 67801	
	CARD NO:	XXXXXXXXXXXX9231	AUTH CODE: 035546
	NAME ON CARD:	PETER D MYERS	
	EXPIRES:	06/30/2006	
	SIGNATURE:		

REMARKS

This receipt was generated by the automated BLM Collections and Billing System and is a paper representation of a portion of the official electronic record contained therein.

AFIDAVIT OF PERFORMANCE OF ANNUAL WORK

STATE OF KANSAS )  
COUNTY OF FORD ) ss.

AMC 361755  
361955

PETE MYERS, being duly sworn, according to law, deposes and says:

That he is a citizen of the United States, more than 18 years of age and resides at 2207 CRESCENT DR. DODGE CITY, FORD County, KANSAS

That he is personally acquainted with the following unpatented mining claims which are situated in the HARTFORD Mining District, COCHISE County, Arizona, the name(s), RECORDING NUMBER of the recording of the location notice(s) in the office of the recorder of said county and the BLM serial numbers of which are as follows:

Claim Name	RECORDING NUMBER	BLM No.
N.D.# 10	040617412	AMC 361755
N.D.# 11	040617413	AMC 361756
N.D.# 12	040620541	AMC 361955
N.D.# 13	040620540	AMC 361956

That the notices of location of said claims are posted within the following Section(s), 30 Township(s) T-23-S and R-20-E Range(s):

That D.D. EXPLORATION, I.I.C., whose address is 2207 CRESCENT DR., DODGE CITY, KS 67801, is the owner of the above-described claims;

That between the dates of JULY 12, 2004 and JULY 25, 2004 in excess of ONE THOUSAND Dollars (\$ 1,000.00 ) worth of work and improvements were done and performed upon or for the benefit of this claim group;

That such work and improvements consisted of ABOVE GROUND AND BELOW GROUND SAMPLING and were performed by PETE MYERS, STEVE CRANE; and

That the above work and improvements were made by and at the expense of PETE MYERS AND STEVE CRANE for D.D. EXPLORATION, I.I.C. the owner of the claims, for the purpose of complying with the laws of the United States pertaining to assessments or annual work.

DATED this 21st day of December, 2004.

SUBSCRIBED AND SWORN to before me this 21st day of December, 2004 by Pete Myers.

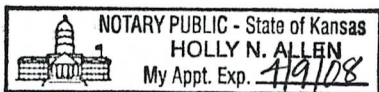

Holly N. Allen  
Notary Public

My Commission Expires:

4/9/08

BLM,

Please record this  
Affidavit.

Please call if you  
have any questions.

Thanks,

Pete Meyer

620 430 3188

**United States Department of the Interior**  
**Bureau of Land Management**  
 BUSINESS & SUPPORT SVCS DIV  
 222 N CENTRAL AVE  
 PHOENIX, AZ 85004 -2203  
 Phone: (602) 417-9200

Receipt

No: 1004405

<b>Transaction #:</b> 1039981	
<b>Date of Transaction:</b> 12/22/2004	
<b>CUSTOMER:</b>	PETER MYERS 2207 CRESCENT DODGE CITY,KS 67801

LINE #	QTY	DESCRIPTION	REMARKS	UNIT PRICE	TOTAL
1	1.00	LOCATABLE MINERALS / MINING CLAIMS- NOT NEW-UNADJUD,ONE AUTH NO. ONLY / MINING CLAIM MONEY RECEIVED (455) <b>CASES: AMC361755/\$20.00</b>	POL 2004 (4)	- n/a -	20.00
<b>TOTAL:</b>					<b>\$20.00</b>

PAYMENT INFORMATION					
1	<b>AMOUNT:</b>	\$20.00	<b>POSTMARKED:</b>	N/A	
	<b>TYPE:</b>	CHECK	<b>RECEIVED:</b>	12/22/2004	
	<b>CHECK NO:</b>	8415			
	<b>NAME:</b>	MYERS, PETER D 2207 CRESCENT DODGE CITY KS 67801			

<b>REMARKS</b>	

This receipt was generated by the automated BLM Collections and Billing System and is a paper representation of a portion of the official electronic record contained therein.

E-RECEIVED IN COMPUTER  
1/6/05 MJA

499

FORM APPROVED  
OMB NO. 1004-0114  
Expires: December 31, 2006

**MAINTENANCE FEE WAIVER CERTIFICATION**

SEE INSTRUCTIONS ON REVERSE AMC 361755 AMC 361955

1. This small miner waiver is filed for the assessment year beginning at noon on September 1, 2004 and ending at noon on September 1, 2005.
2. The undersigned and all related parties owned ten or fewer mining claims, mill, or tunnel sites located and maintained on Federal lands in the United States of America on September 1, 2004.
3. The undersigned have performed the assessment work required by law for each mining claim listed prior to filing this waiver and understand that by filing this form; an affidavit of assessment work must be recorded by the December 30th following the filing of this waiver.
4. The undersigned understand that if the assessment work obligation has not yet come due under 30 U.S.C. 28 (for those claims in their first assessment year only); a notice of intent to hold reciting this condition must be recorded by the December 30th following the filing of this waiver.
5. The undersigned understand that mill and tunnel sites may also be listed upon this waiver and be waived from payment of the maintenance fee; and that a notice of intent to hold for these sites is required to be recorded by the December 30th immediately following the filing of this waiver.
6. The undersigned understand and acknowledge that pursuant to 43 U.S.C. 1212 and 18 U.S.C. 1001; the filing or recording of a false, fictitious, or fraudulent document with the Bureau of Land Management may result in a fine of up to \$250,000, a prison term not to exceed five years, or both.
7. The mining claims, mill or tunnel sites for which this waiver from payment of the maintenance fees is requested are:

CLAIM OR SITE NAME	BLM RECORDATION SERIAL NUMBER
1. N.D. #10	AMC 361755
2. N.D. #11	AMC 361756
3. N.D. #12	AMC 361955
4. N.D. #13	AMC 361956
5.	
6.	
7.	
8.	
9.	
10.	

RECEIVED  
 BUREAU OF  
 LAND MANAGEMENT  
 2004 SEP - 1 A 9: 59  
 ARIZONA  
 STATE OFFICE  
 PHOENIX, ARIZONA

*Pete Myers*  
(Owner's Signature)

The owner(s) (claimants) of the above mining claims and sites are:

D.D. EXPLORATION LLC  
(Owner's Name - Please Print)

2207 CRESCENT DR.  
(Street or P.O. Box)  
DODGE CITY KS 67801  
(City) (State) (Zip Code)

\_\_\_\_\_  
(Owner's Name - Please Print)

\_\_\_\_\_  
(Street or P.O. Box)  
\_\_\_\_\_  
(City) (State) (Zip Code)

\_\_\_\_\_  
(Owner's Name - Please Print)

\_\_\_\_\_  
(Street or P.O. Box)  
\_\_\_\_\_  
(City) (State) (Zip Code)

(Continued on page 2)

ENTERED IN COMPUTER

10/18/04 *mx*

#8-30-04

BLM,

RECEIVED  
BUREAU OF  
LAND MANAGEMENT

Please file my

2004 SEP -1 A 9:59

"Maintenance Fee Waiver  
Certification"

ARIZONA  
STATE OFFICE  
PHOENIX, ARIZONA

If you have any  
questions or problems  
please contact me. 620  
430 3188. Thank you.

Yours Truly,

Pete Myers

**NOTICE!!**

**These documents have been scanned!**

**Do not place un-scanned documents beneath this notice!**

**Do not remove this notice from this file!**

GPO Jacket No. 560-102  
Print Order 61540  
Rise Business Services, LLC  
Job=AZ15 6/5/2019



Box Number= AZ15118



Claim Begin-End: AMC361755-AMC361756

**5 Miscellaneous**



AZ15118-4 AMC361381-AMC361966

**NO  
DOCUMENTS  
FOUND**

NO DOCUMENTS FOUND  
NO DOCUMENTS FOUND



**NOTICE!!**

**These documents have been scanned!**

**Do not place un-scanned documents beneath this notice!**

**Do not remove this notice from this file!**

GPO Jacket No. 560-102  
Print Order 61540  
Rise Business Services, LLC  
Job=AZ15 6/5/2019



Box Number= AZ15118



Claim Begin-End: AMC361755-AMC361756

**6 Location Notices-Amendments and Supporting Documents**



AZ15118-4

AMC361381-AMC361966

AMENDED LOCATION NOTICE

(LODE)

This is an amendment to the N.D. #10 lode claim, located on May 24, 2004 and of record with the recording number 040617412 in the office of the County Recorder of Cochise County Arizona.

NOTICE IS HEREBY GIVEN that the N.D. #10 (AMC 361755) lode mining claim has been located and now amended by D.D. Exploration LLC, whose current mailing address is 2207 Crescent Dr., Dodge City, KS 67801. The general course of this claim is ESE TO WNW and it is situated in COCHISE County, Arizona. HARTFORD MINING DISTRICT.

This Claim is 1475 Feet in length and 590 Feet in width. This claim runs from location monument on which this location notice is posted approximately 737.5 Feet in a Easterly direction to the Eastern end line and 737.5 in a Westerly direction to the Western end line. This claim is marked by six monuments, one at each corner and one at the center of each end line of the claim.

The location monument on which this notice is posted is situated within Section 30, T.-23-S., R.-20-E., G&SRM, Arizona, and this claim encompasses portions of the following quarter section (s), Section (s), Township(s) and Range (s): SW/4 of SECTION 30 AND NW/4 OF SECTION 31, T-23-S, R-20-E G&SRM, Arizona.

THIS CLAIM EXCLUDES AND DOES NOT INCLUDE ANY PRIVATE LAND AND OR PATENTED LAND AND OR LAND WITHDRAWN FROM MINERAL ENTRY.

The locality of this claim with reference to some natural object or permanent monument and additional information (if any) concerning its locality are as follows: FROM U.S.L.M 2171 TO THE SOUTHWEST CORNER OF KPD #010 THE APP. BEARING OF 210° FOR THE APP. DISTANCE OF 1913 FT. SOUTHERN LINE OF N.D. #10 IS THE SAME AS THE NORTHERN LINE OF N.D. # 11. THE EASTERN LINE OF N.D. #10 IS THE SAME AS THE WESTERN LINE OF KPD #017 AND THE NORTHERN LINE OF N.D. #10 IS THE SAME AS THE SOUTHERN LINE OF KPD #012 AND THE WESTERN LINE OF N.D. #10 IS THE SAME AS THE EASTERN LINE OF N.D. #12.

DATED AND POSTED on the ground this 24th day of June 2005

LOCATOR (S): Peter Myer

RECEIVED BUREAU OF LAND MANAGEMENT ARIZONA STATE OFFICE PHOENIX, ARIZONA 2005 JUL 12 P 12:41

AMC 361755

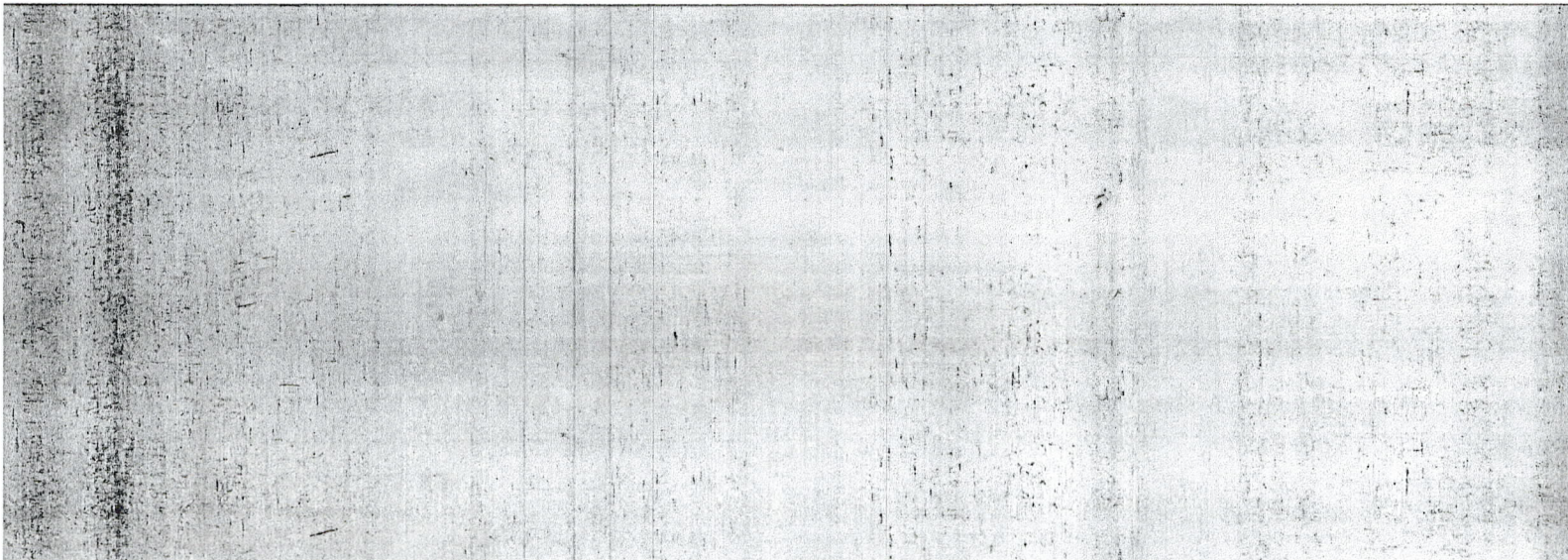

AMENDED CLAIM MAP  
N.D.#10 (AMC-361755)

Lode Placer (XX)

NORTH

BEARINGS IN DEGREES

DISTANCES IN FEET

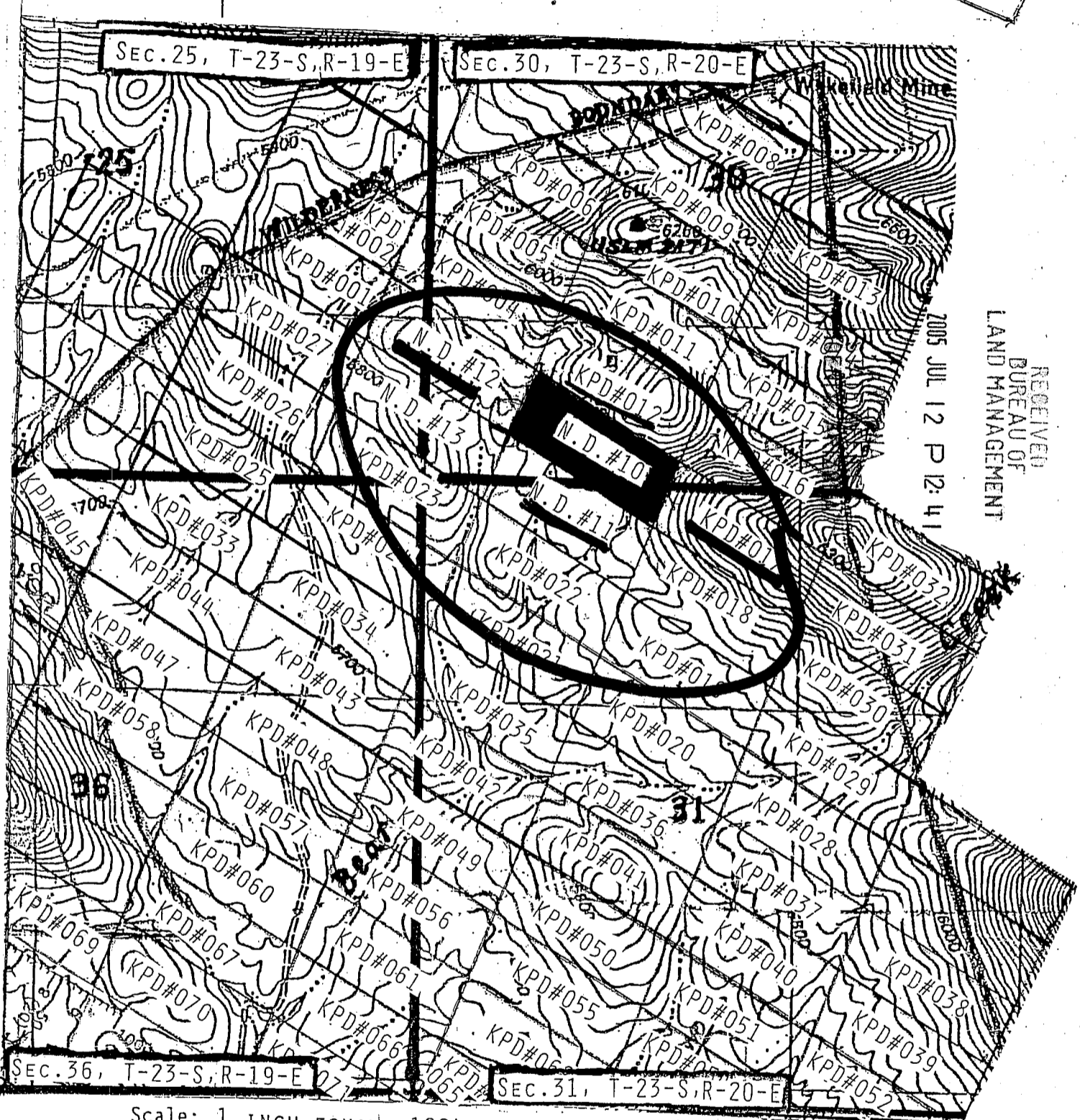
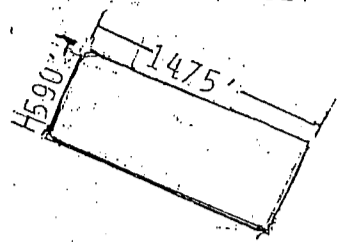
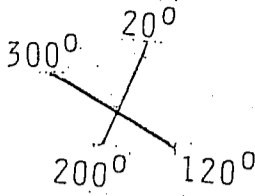

RECEIVED  
BUREAU OF  
LAND MANAGEMENT  
2005 JUL 12 P 12:41

Scale: 1 INCH EQUALS 1224 FT.

1. The above map depicts the N.D.#10 (AMC-361755) mining claim, which is located in Section (s) 30 & 31, Township -23- SOUTH, Range -20- EAST, G&SRM, COCHISE County, Arizona.
2. The type of corner and location monuments used are as follows:  
2X2 OR LARGER WOOD POSTS
3. The bearings and distances in degrees and feet between claim corners are as depicted on map.

LOCATION NOTICE  
(LODE)

NOTICE IS HEREBY GIVEN that the N.D. # 10 lode mining claim has been located by D.D. EXPLORATION LLC whose current mailing address is 2207 CRESCENT DRIVE, DODGE CITY, KS 67801.

The general course of this claim is HARTFORD DISTRICT and it is situated in COCHISE County, Arizona.

This claim is 1500 feet in length and 600 feet in width.

This claim runs from the location monument on which this location notice is posted approximately 750 feet in a 110° EAST direction to the EAST end line and 750 feet in a 290° WEST direction to the WEST end line. This claim is marked by six monuments, one at each corner and one at the center of each end line of the claim.

The location monument on which this notice is posted is situated within Section 30, T. 23 S., R. 20 E., G&SRM, Arizona, and this claim encompasses portions of the following quarter section(s), Section(s), Township(s) and Range(s): SW/4 SEC. 30, T-23-S, R-20-E, G&SRM, Arizona.

The locality of this claim with reference to some natural object or permanent monument and additional information (if any) concerning its locality are as follows: CENTER OF WEST LINE BY G.P.S. 31° 23.700" NORTH,  
110° 21.086" WEST

DATED AND POSTED on the ground this 24 day of MAY, 2004.

LOCATOR(S):

Pete Myers  
PETE MYERS

RECEIVED  
BUREAU OF  
LAND MANAGEMENT

2004 JUN -1 A 10:53

ARIZONA  
STATE OFFICE  
PHOENIX, ARIZONA

AMC 361755

CLAIM MAP

Lode (XX)  
Placer ( )

NORTH

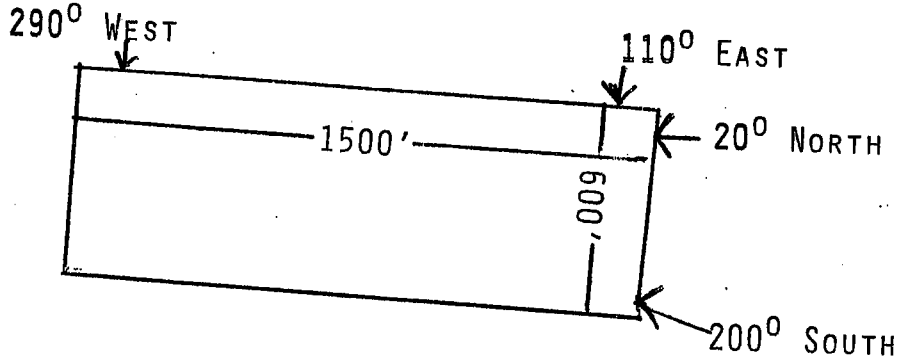

RECEIVED  
BUREAU OF  
LAND MANAGEMENT

2004 JUN - 1 A 10: 53

ARIZONA  
STATE OFFICE  
PHOENIX, ARIZONA

AMC 361755

N

Scale: 1" EQUALS 500'

1. The above map depicts the N.D. # 10 mining claim, which is located in Section (s) 30, Township 29 S, Range 20 E, G&SRM, COCHISE County, Arizona.

2. The type of corner and location monuments used are as follows:

2X2 WOOD POSTS

3. The bearings and distances in degrees and feet between claim corners are as depicted on map.

AMENDED LOCATION NOTICE

(LODE)

This is an amendment to the N.D. #11 lode claim, located on May 24, 2004 and of record with the recording number 040617413 in the office of the County Recorder of Cochise County Arizona.

NOTICE IS HEREBY GIVEN that the N.D. #11 (AMC 361756) lode mining claim has been located and now amended by D.D. Exploration LLC, whose current mailing address is 2207 Crescent Dr., Dodge City, KS 67801. The general course of this claim is ESE TO WNW and it is situated in COCHISE County, Arizona. HARTFORD MINING DISTRICT.

This Claim is 1475 Feet in length and 590 Feet in width. This claim runs from location monument on which this location notice is posted approximately 737.5 Feet in a Easterly direction to the Eastern end line and 737.5 in a Westerly direction to the Western end line. This claim is marked by six monuments, one at each corner and one at the center of each end line of the claim.

The location monument on which this notice is posted is situated within Section 31, T.-23-S, R.-20-E, G&SRM, Arizona, and this claim encompasses portions of the following quarter section (s), Section (s), Township(s) and Range (s): NW/4 of SECTION 31 AND SW/4 OF SECTION 30, T-23-S, R-20-E G&SRM, Arizona.

***THIS CLAIM EXCLUDES AND DOES NOT INCLUDE ANY PRIVATE LAND AND OR PATENTED LAND AND OR LAND WITHDRAWN FROM MINERAL ENTRY.***

The locality of this claim with reference to some natural object or permanent monument and additional information ( if any ) concerning its locality are as follows: FROM U.S.L.M 2171 TO THE NORTHWEST CORNER OF KPD #011 THE APP. BEARING OF 210° FOR THE APP. DISTANCE OF 1913 FT. NORTHERN LINE OF N.D. #11 IS THE SAME AS THE SOUTHERN LINE OF N.D. # 10 AND THE EASTERN LINE OF N.D. #11 IS THE SAME AS THE WESTERN LINE OF KPD #018 AND SOUTHERN LINE OF N.D. #11 IS THE SAME AS NORTHERN LINE OF KPD #022 AND WESTERN LINE OF N.D. #11 IS THE SAME AS EASTERN LINE OF N.D. #13.

DATED AND POSTED on the ground this 24th day of June 2005

LOCATOR (S): Peter Myer

RECEIVED  
BUREAU OF  
LAND MANAGEMENT  
2005 JUL 12 P 5:4  
ARIZONA  
STATE OFFICE  
PHOENIX, ARIZONA

AMC 361756

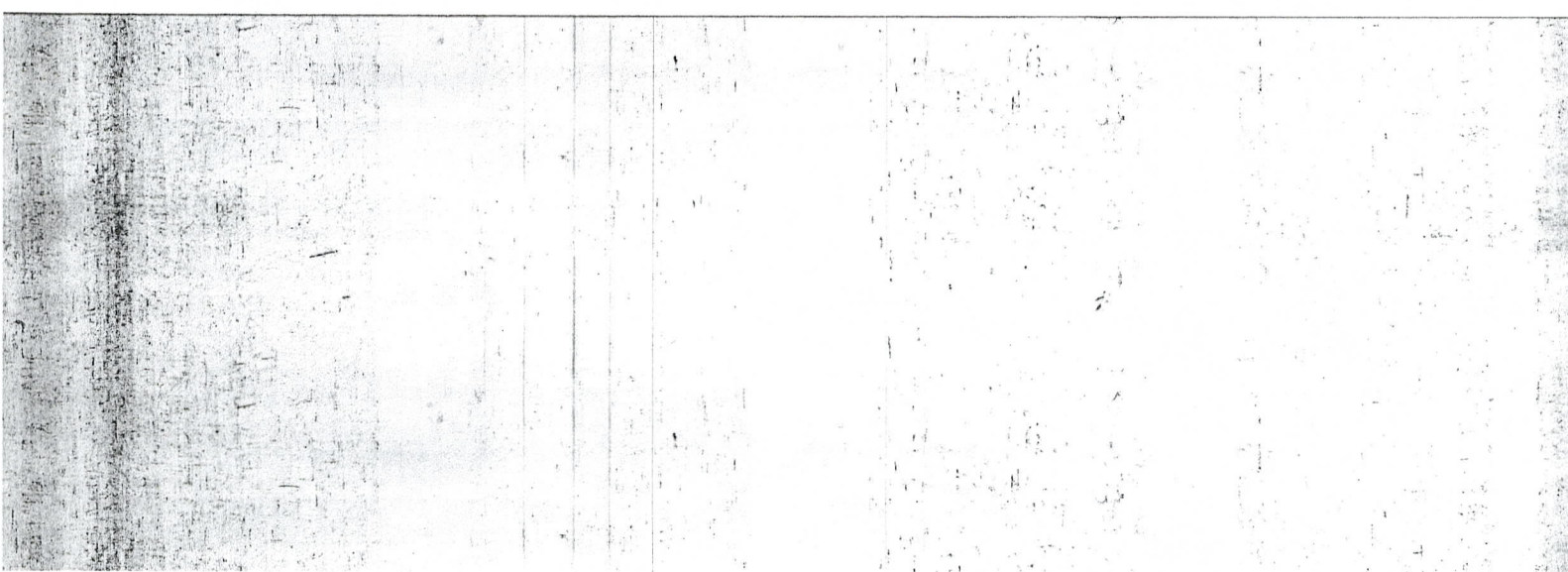

AMENDED CLAIM MAP  
N.D.#11 (AMC-361756)

Lode Placer (XX)

NORTH

BEARINGS IN DEGREES

DISTANCES IN FEET

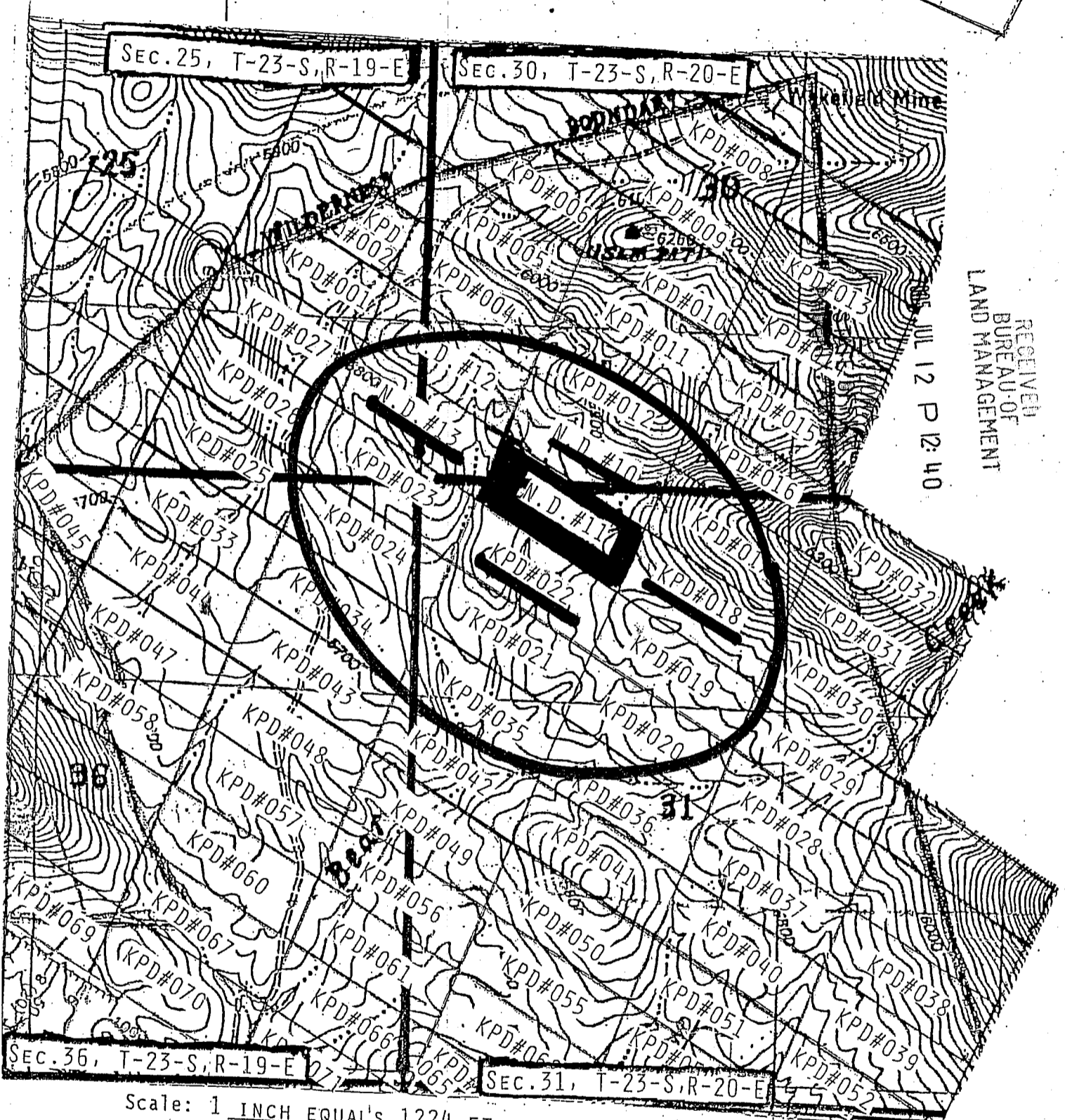
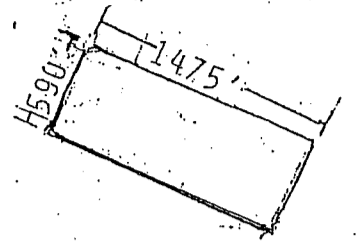
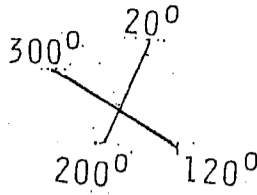

Scale: 1 INCH EQUALS 1224 FT.

1. The above map depicts the AMENDED N.D.#11(AMC-361756) mining claim, which is located in Section (s) 30 & 31, Township -23- SOUTH, Range -20- EAST, G&SRM, COCHISE County, Arizona.
2. The type of corner and location monuments used are as follows:  
2X2 OR LARGER WOOD POSTS
3. The bearings and distances in degrees and feet between claim corners are as depicted on map.

LOCATION NOTICE  
(LODE)

NOTICE IS HEREBY GIVEN that the N.D. # 11 lode mining claim has been located by D.D. EXPLORATION LLC whose current mailing address is 2207 CRESCENT DRIVE, DODGE CITY, KS 67801.

The general course of this claim is HARTFORD DISTRICT and it is situated in COCHISE County, Arizona.

This claim is 1500 feet in length and 600 feet in width. This claim runs from the location monument on which this location notice is posted approximately 750 feet in a 110° EAST direction to the EAST end line and 750 feet in a 290° WEST direction to the WEST end line. This claim is marked by six monuments, one at each corner and one at the center of each end line of the claim.

The location monument on which this notice is posted is situated within Section 30, T. 23 S., R. 20 E., G&SRM, Arizona, and this claim encompasses portions of the following quarter section(s), Section(s), Township(s) and Range(s): SW/4 SEC. 30, T-23-S, R-20-E, G&SRM, Arizona.

The locality of this claim with reference to some natural object or permanent monument and additional information (if any) concerning its locality are as follows: CENTER OF WEST LINE BY G.P.S. 31° 23.606" NORTH  
21.143" WEST

DATED AND POSTED on the ground this 24 day of MAY, 192004.

LOCATOR(S):

Pete Myers  
PETE MYERS

RECEIVED  
BUREAU OF  
LAND MANAGEMENT

2004 JUN - 11 AM 5:53

ARIZONA  
STATE OFFICE  
PHOENIX, ARIZONA

ANC 361756



CLAIM MAP

Lode (XX)  
Placer ( )

NORTH

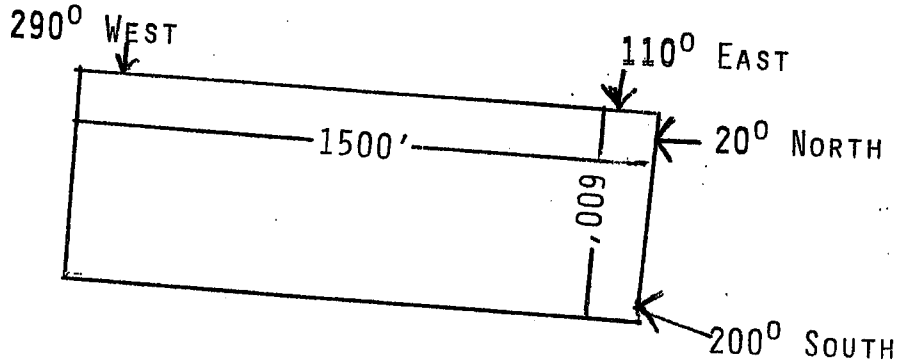

RECEIVED  
BUREAU OF  
LAND MANAGEMENT

2004 JUN -1 A 10:53

ARIZONA  
STATE OFFICE  
PHOENIX, ARIZONA

AMP 361756

N

Scale: 1" EQUAL'S 500'

1. The above map depicts the N.D. #11 mining claim, which is located in Section (s) 30, Township 29 S, Range 20 E, G&SRM, COCHISE County, Arizona.

2. The type of corner and location monuments used are as follows:  
2X2 WOOD POSTS

3. The bearings and distances in degrees and feet between claim corners are as depicted on map.

**MINING CLAIM STATUS REPORT**

Status Checked By:	_____
MTP Checked By:	_____
GEO Checked By:	_____
Preadjudication By:	_____
Final Adjudication By:	_____

LEAD SERIAL NO. AMC 361755 THROUGH AMC 361756

<u>2</u> LODE	@ \$25 = \$ _____	Location Fee
PLACER	@ \$10 = \$ _____	Service Fee--curable defect
MILL SITE	@ \$100 = \$ _____	Claim Maintenance Fee
TUNNEL SITE	\$ _____	<b>TOTAL FEES</b>
ASSOCIATION	\$ _____	Copy Fees,
PLACER	\$ _____	Overage <input type="checkbox"/> Shortage <input type="checkbox"/>
	\$ <u>200</u>	<b>TOTAL RECEIVED</b>

OVER-THE-COUNTER:  MAIL:  Timely Filed: YES  NO

LEGAL DESCRIPTION:

T <u>235</u> R _____ S _____	T _____ R _____ S _____
T <u>235</u> R <u>20E</u> S <u>3D</u>	T _____ R _____ S _____
T _____ R _____ S _____	T _____ R _____ S _____
T _____ R _____ S _____	T _____ R _____ S _____

GENERAL JURISDICTION: BLM  or NATIONAL FOREST  CORONADO NF  
Name

SPLIT ESTATE LAND SX  PX  SRHE  OTHER  \_\_\_\_\_  
Specify

WILDERNESS AREA (WA): \_\_\_\_\_  
Specify

CLAIMS SUBJECT TO PL 359: YES  NO

PROPER NOTICE FILED IF LOCATING ON SRHE: YES  NO

COMMENTS: \_\_\_\_\_  
\_\_\_\_\_  
\_\_\_\_\_

STATUS: PARTIALLY VOID  VOID   
PRIVATE MINERALS  WITHDRAWN  OTHER

COMMENTS: \_\_\_\_\_  
Claim located on patented lands #4 5395 P/C  
Exp grant deced. and own minerals - amended OK  
\_\_\_\_\_  
\_\_\_\_\_  
\_\_\_\_\_  
\_\_\_\_\_  
\_\_\_\_\_

Input Parameters for Geographic Report with Land

System Id = CR

Admin State = AZ

Geo State = AZ

Casetype Begins With 16, 18, 20, 21, 22, 23, 24, 25, 26, 27, 28, 29, 31, 32, 35, 36, 38, 39, 8370, 88, 92

Case Disp Txt = AUTHORIZED, PENDING

Mer Twp Rng =

Section =

Mtrs = 14 0230S 0200E 030, 14 0230S 0200E 031

Commodity =

Commodity Txt =

Pending Org =

Pend Org Decode =

Total Rows Returned: 2

RUN TIME: 01:18 PM

UNITED STATES DEPARTMENT OF INTERIOR  
BUREAU OF LAND MANAGEMENT  
GEOGRAPHIC REPORT WITH LAND  
Sorted by Serial Number

RUN DATE: 02/13/2006

Page 1 of 1

Adm State: AZ

Serial Number: AZA 028556  
Total Case Acres: 20,131.000

*Miller Peak  
Wilderness Area*

<u>Casetype</u>	<u>Case Disp</u>	14	0230S	0200E	<u>Sect</u>	<u>Sur Typ</u>	<u>Sur Num</u>	<u>Suff</u>	<u>Subdivision</u>	<u>Act Pend</u>
232107	AUTHORIZED				030	FF		1	M&B;	
					031			1		





Peter D. Myers

**RE/MAX** Professionals

1206 Frontview, Suite 202 • Dodge City, Kansas 67801

Each Office Independently Owned and Operated



Alt. Accounts

B. L. M.  
Arizona State Office  
222 N. Central Ave  
Phoenix, AZ 85004

ARIZONA  
STATE OFFICE  
PHOENIX, ARIZONA

2001 JUN - 1 A 10: 53

RECEIVED  
BUREAU OF  
LAND MANAGEMENT